

2 SECOND FLOOR FRAMING PLAN

- Holddowns located at the 2nd floor.
- Shearwalls are from the foundation to the 2nd floor sheathing.

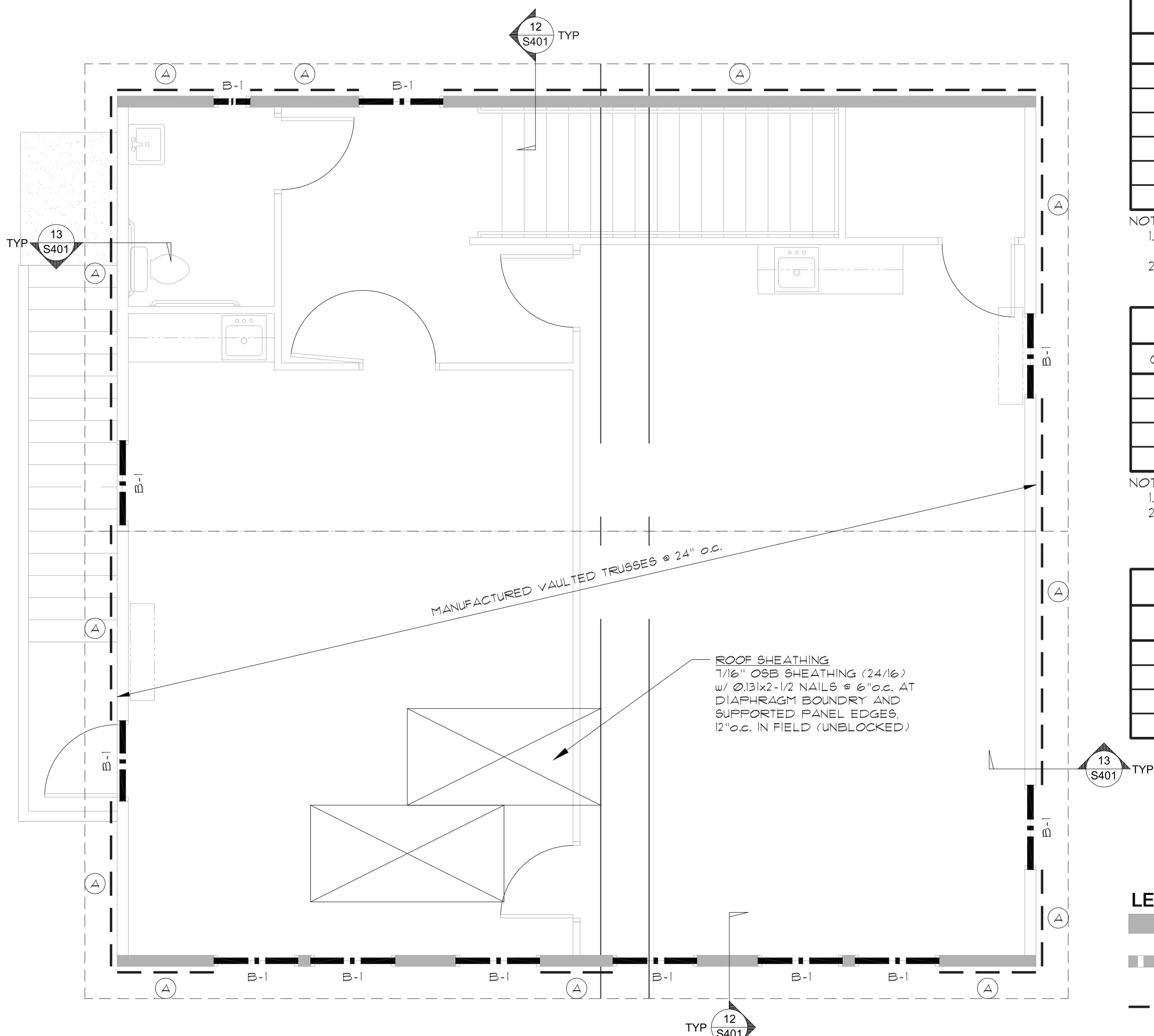

1 ROOF FRAMING PLAN

- Shearwalls are from the 2nd floor to the roof sheathing.

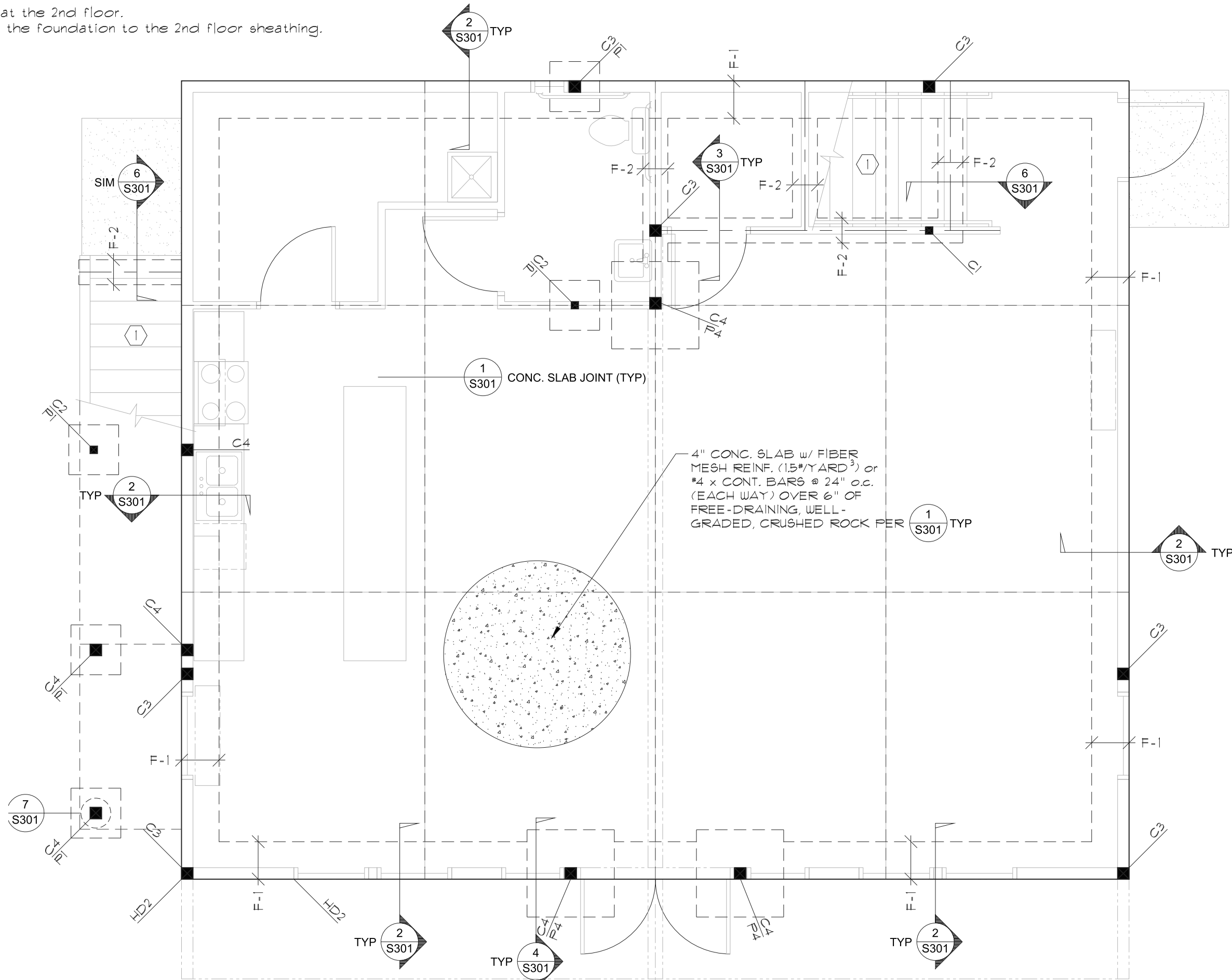

1 FOUNDATION PLAN

- Holddowns located at the foundation.

Refer to Architectural drawings for all dimensions.

BEAM SCHEDULE		
BEAM	BEAM SIZE	BEAM TYPE AND GRADE
B-1	4x8	#2 DFL
B-2	4x10	#2 DFL
B-3	4x12	#2 DFL
B-4	3 1/2 x14	2OE REDLAM
B-5	5 1/2 x12	SEE NOTE #1
B-6	2 3/4 x12	SEE NOTE #1

- NOTES:
1. SIMPLE SPANS (24F-V4)
  2. MULTIPLE & CANTILEVERED SPANS (24F-V8)
  3. ALL BEAMS EXPOSED TO WEATHER or IN DIRECT CONTACT w/ SOIL or CONCRETE TO BE PRESSURE TREATED or WRAPPED

COLUMN SCHEDULE		
COLUMN	COLUMN SIZE	TYPE AND GRADE
C1	(2) 2x4	#2 DFL
C2	4x4	#2 DFL
C3	(2) 2x6	#2 DFL
C4	6x6	#2 DFL

- NOTES:
1. NOTE ALL COLUMNS MAY BE USED IN THIS PROJECT.
  2. ALL COLUMNS EXPOSED TO WEATHER or IN DIRECT CONTACT w/ SOIL or CONCRETE TO BE PRESSURE TREATED or WRAPPED

PAD FOOTING SCHEDULE			
MARK	FOOTING SIZE (Ft x Ft x Depth in UNO)	ALLOWABLE LOADS (kips)	REINFORCEMENT (each way)
F-1	2x2	5.5	(3) #4 BARS
F-2	2.5x2.5	8.6	(3) #4 BARS
F-3	3x3	12.0	(3) #4 BARS
F-4	3.5x3.5	17.8	(4) #4 BARS

- LEGEND**
- 2x6 #2 DFL @ 16" o.c. w/ #2 DFL TOP & BOTTOM PLATES BEARING WALL
  - 2x4 #2 DFL @ 16" o.c. w/ #2 DFL TOP & BOTTOM PLATES BEARING WALL
  - SHEARWALL (SEE TABLE T1 ON S-100)
  - (C) COLUMN- SIZE PER SCHEDULE
  - (F) PAD FOOTING- SIZE PER SCHEDULE
  - HOLDOWN- SEE TABLE T2
  - 20" WIDE x 26" THICK FOOTING w/ (2) #4 x CONT. BARS TOP & BOTTOM and VERT. DOVEL BARS @ 18" o.c. PER DETAIL 2/5-301
  - 12" WIDE x 12" THICK FOOTING w/ (2) #4 x CONT. BARS TOP & BOTTOM and VERT. DOVEL BARS @ 18" o.c. PER DETAIL 3/5-301

- NOTES**
1. REFER TO GENERAL STRUCTURAL NOTES SECTION "STRUCTURAL WOOD" NOTE F ANY NAILING NOT NOTED.
  2. FRAME ALL WINDOW/DOOR OPENINGS w/ (1) 2x6 KING STUD and (1) 2x6 CRIPPLE STUD (UNO.)
  3. REFER TO DETAIL 1/5-401 FOR TOP PLATE CONTINUITY.
  4. ADD (2) 2x STUDS UNDER ALL HEADERS, BEAMS or GIRDER TRUSSES (UNO.)
  5. SOLID BLOCKING IN FLOOR JOIST SPACE REQUIRED UNDER ALL WOOD COLUMNS. BLOCKING TO BE SAME CROSS SECTIONAL AREA AS COLUMNS.
  6. HANGERS NOTED ARE SIMPSON STRONG-TIES.
  7. SUPPORT ALL NON BEARING WALLS PER DETAILS 14 & 15/5-401.
  8. ALL NON-BEARING HEADERS SHALL BE (2) 2x8 #2 DFL (UNO.)
  9. COORDINATE w/ MECHANICAL DRAWINGS FOR HVAC DUCT SIZES AND LOCATIONS.

- DRAWING NOTES**
1. REFER TO SHEETS S-501 FOR ALL STAIR FRAMING & DETAILS.
  2. SIMPSON M8T126 STRAP w/ (26) #14x1-1/2 NAILS. PER DETAIL 9/5-401
  3. SIMPSON C520 x 12" STRAP w/ #13x2-1/2" NAILS @ 4" o.c. PER DETAIL 10/5-401.

TABLE T.2 HOLDOWN SCHEDULE								
MARK	HOLDOWN	ANCHOR BOLT	ANCHOR SIZE	EMBED LENGTH	WOOD MEMBER	ANCHORAGE TO WOOD	DETAILS	ALLOW. LOAD (lbs.)
HD1	C520 w/ 9" END LENGTH	-	-	-	2x STUD	(14) #13 x 2 1/2" NAILS	PER DETAIL 11/5-401	1030
HD2	HDU4	S8TB24L	5/8" x 9"	20 3/8"	(2) 2x STUDS	(10) S8S 1/4" x 2 1/2" SCREWS	PER DETAILS 8 & 9/5-301	3325

- NOTES:
1. NOT ALL HOLDOWNS MAY BE USED ON THIS PROJECT.
  2. ON ALL HD HOLDOWNS, PLACE ONE (1) EXTRA VERTICAL #4 BAR FROM FOOTING INTO STEMWALL NEXT TO HD.



**Dan Green Engineering, Inc.**  
Structural Engineers  
3230 Triangle Drive S.E.  
Salem, Oregon 97302-4506  
Phone 503-391-2309  
Fax 503-566-8660

JOB NO. 220517  
DATE: 01/18/23

FILE: S-201 Found

REVISION	
DATE	

FOUNDATION, 2nd FLOOR and ROOF FRAMING  
NORTHGATE CHURCH  
PRAYER BUILDING ADDITION  
2405 CARLETON WAY NE, SALEM, OREGON

SHEET NO.  
**S-201**  
2 OF 5