

**Non-SFR < 10,000 Square Feet:**  
SRC does not require Non-SFR projects consisting of less than 10,000 square feet of new or replaced impervious surface to provide stormwater flow control or general storm water treatment. However, reducing impervious surface area may reduce SDC fees and stormwater utility rates.

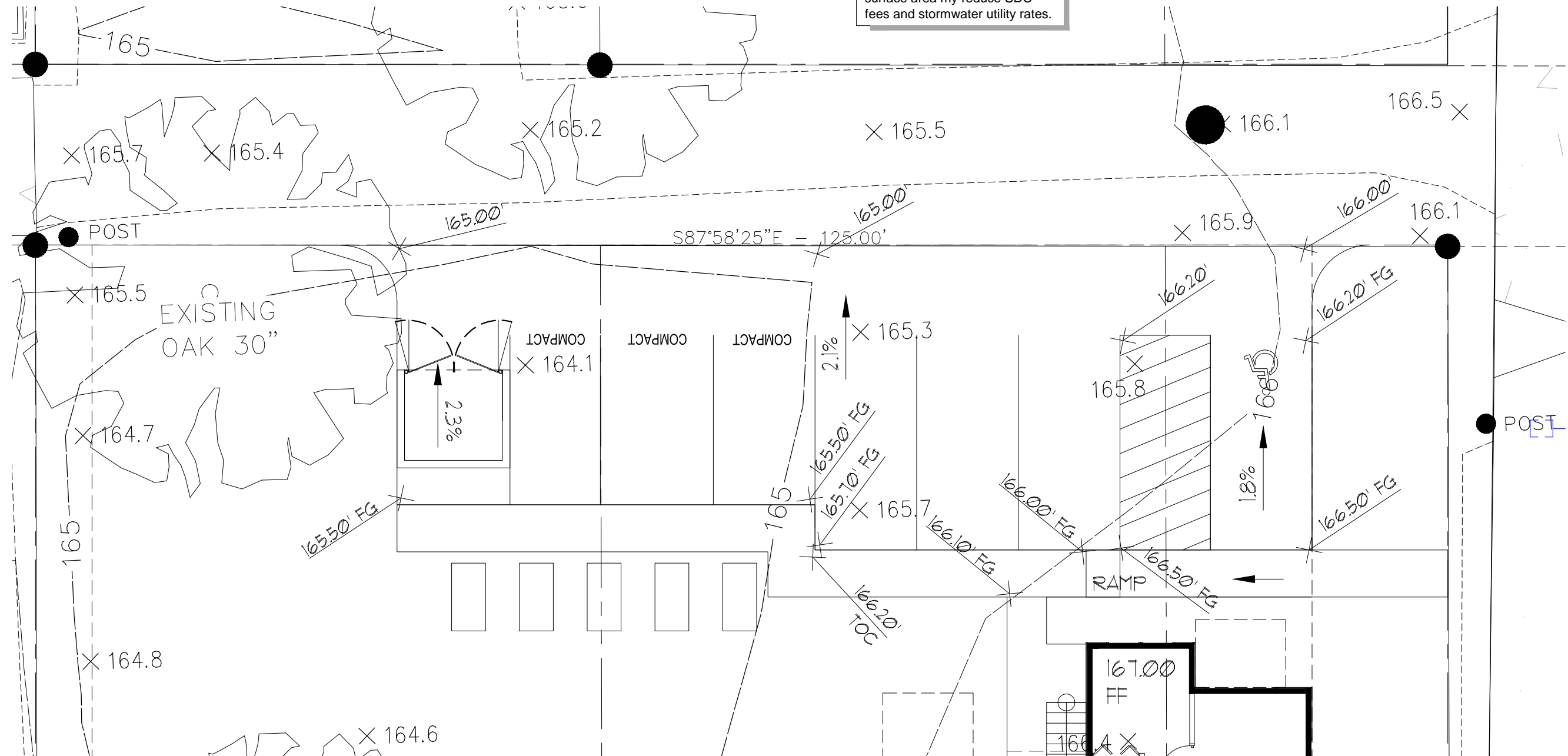

# ENLARGED GRADING PLAN

3) SCALE : 1" = 10'-0"



## Site Plan Review Class 3

**Fahman Glaze Apartments**  
1341 Waller St Salem Or

1341 Waller St., Salem, Or

DATE: 9 JAN 2023  
DRAWN: glm  
JOB NO.: 2207

**SPR 3B**

