

4

SITE DEVELOPMENT PLAN - LEVEL 02  
1" = 20'-0"

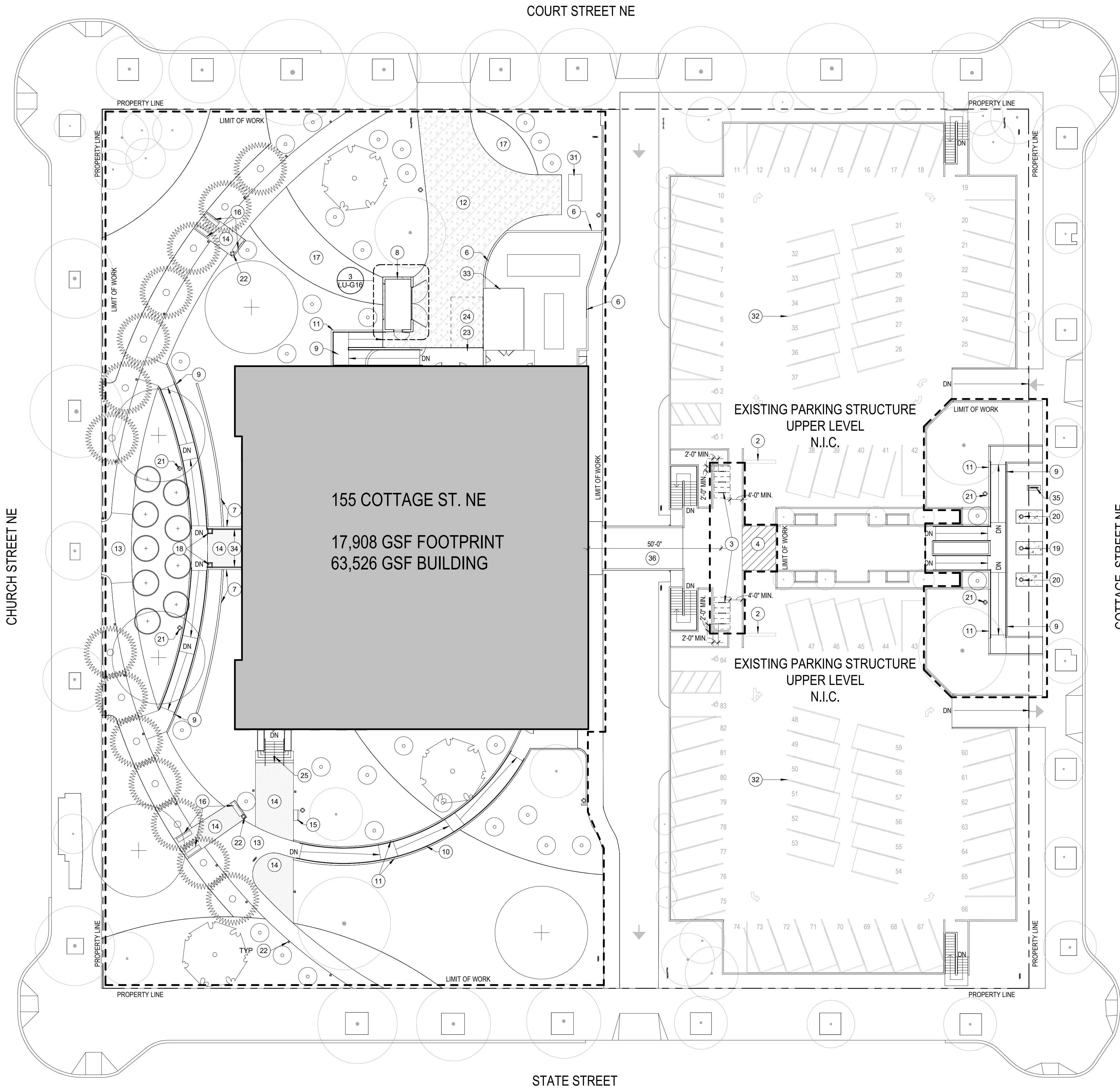

3

ENLARGED PLAN - TRASH ENCLOSURE  
1/4" = 1'-0"

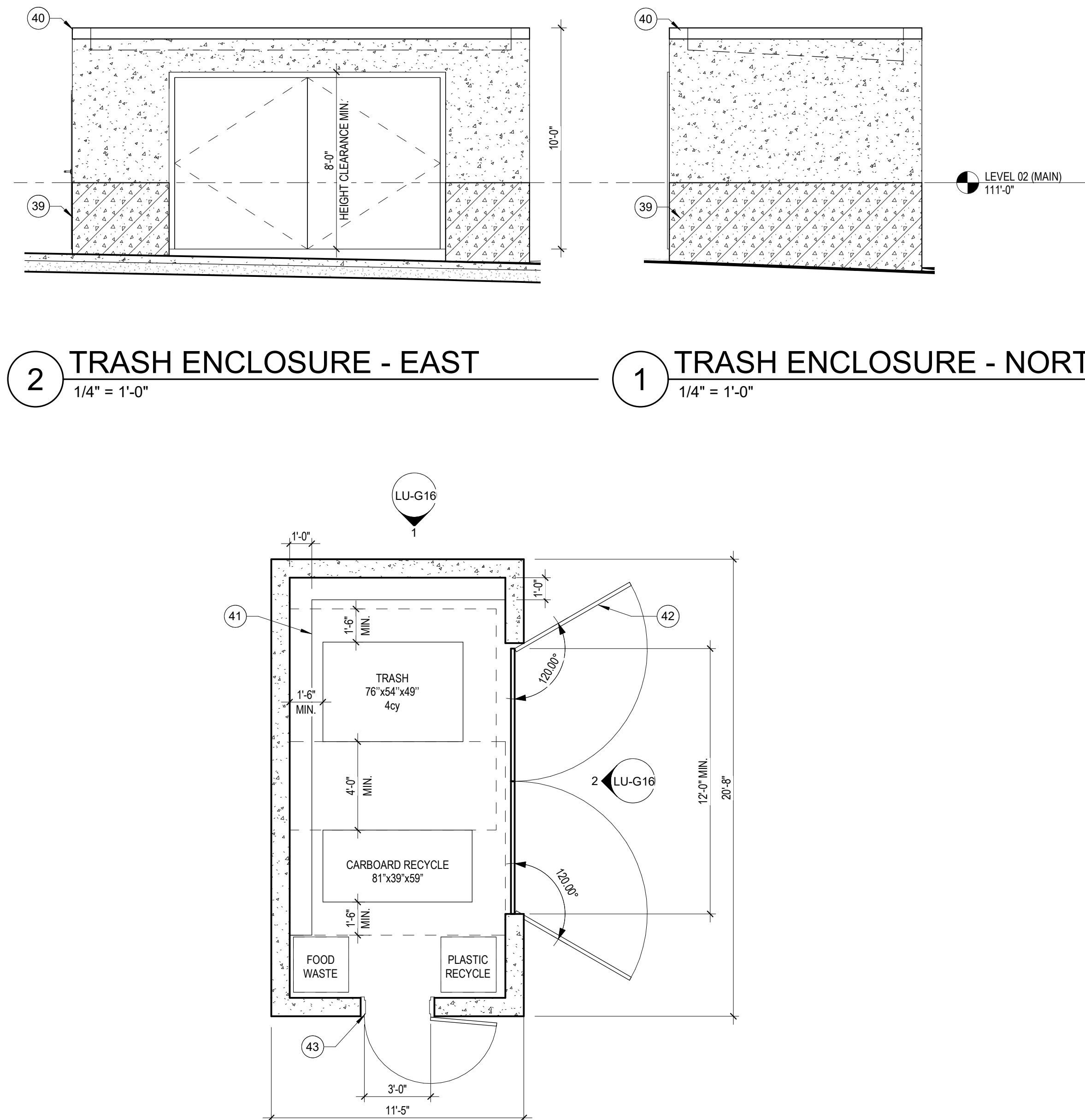

KEYED NOTES - SITE PLAN

- 1 DUAL PORT EV CHARGING STATIONS
- 2 EXISTING SPEED BUMP TO REMAIN
- 3 SHORT-TERM BICYCLE PARKING, 2'W x 6'L x 4'H
- 4 PEDESTRIAN CROSSING STRIPING
- 5 METAL GATE
- 6 CAST-IN-PLACE CONCRETE RETAINING WALL WITH STONE CLADDING
- 7 CAST-IN-PLACE CONCRETE RETAINING WALL
- 8 TRASH ENCLOSURE, 10'H CONCRETE WALLS WITH 8'H OVERHEAD CLEARANCE
- 9 CAST-IN-PLACE CONCRETE ADA ACCESSIBLE RAMP WITH HANDRAILS AS REQUIRED
- 10 CAST-IN-PLACE CONCRETE ADA ACCESSIBLE RAMP WITH HANDRAILS AND IN-WALL EGRESS LIGHTING AS REQUIRED
- 11 CAST-IN-PLACE CONCRETE WALL
- 12 ASPHALT DRIVEWAY
- 13 CONCRETE WALKWAY
- 14 PRECAST CONCRETE PAVERS
- 15 RELOCATED (E) DEDICATION BENCH
- 16 BENCH
- 17 BIORETENTION SWALE
- 18 RELOCATED (E) LIGHT COLUMN
- 19 30' H FLAG POLE WITH 9x6 FLAG
- 20 25' H FLAG POLE WITH 4x6 FLAG
- 21 RELOCATED (E) LIGHT FIXTURE
- 22 LIGHT FIXTURE, TYP.
- 23 EXISTING LOADING DOCK
- 24 LOADING SPACE, 12'W x 19'L x 14'H
- 25 STAIR TO MATCH EXISTING, GRANITE CLAD PLINTHS WITH CONCRETE TREADS AND HANDRAILS
- 26 HEAT PUMP, 7'-3"W x 20'-10"L x 8'-1"H
- 27 EMERGENCY GENERATOR, 8'-2"W x 27'-3"L x 11'-11"H
- 28 EXISTING BOLLARDS TO REMAIN
- 29 EXISTING SERVICE VEHICLE PARKING TO REMAIN
- 30 EXISTING CHILLER ENCLOSURE
- 31 RELOCATED TRANSFORMER, 5'W x 10'L x 4'H
- 32 EXISTING PARKING SPACES TO REMAIN
- 33 EXISTING CHILLER ROOM ROOF
- 34 DECORATIVE METAL HANDRAIL TO MATCH EXISTING
- 35 EXISTING BUILDING ID SIGN
- 36 EXISTING PEDESTRIAN BRIDGE TO REMAIN
- 37 EXISTING PEDESTRIAN BRIDGE ABOVE
- 38 OVERHEAD METAL COILING SECURITY GATE
- 39 GRANITE CLADDING
- 40 PARAPET CAP
- 41 4TH MIN. BUMPER CURB
- 42 METAL GATE WITH RESTRAINER IN OPEN AND CLOSED POSITIONS
- 43 HOLLOW METAL DOOR AND FRAME

LEGEND - SITE PLAN

- EXISTING PAVING AND/OR LANDSCAPE AREA
- VEHICULAR ASPHALT PAVING
- PEDESTRIAN CONCRETE PAVING
- PRECAST CONCRETE PAVERS
- PEDESTRIAN CROSSING STRIPING
- VEHICULAR PATH OF TRAVEL