

F:\2021\A21166.20 - Turner Rd. - Salem - LA\CAD\Sheets\A21166.20.dwg : Feb. 22, 22 - 4:50 PM Hong

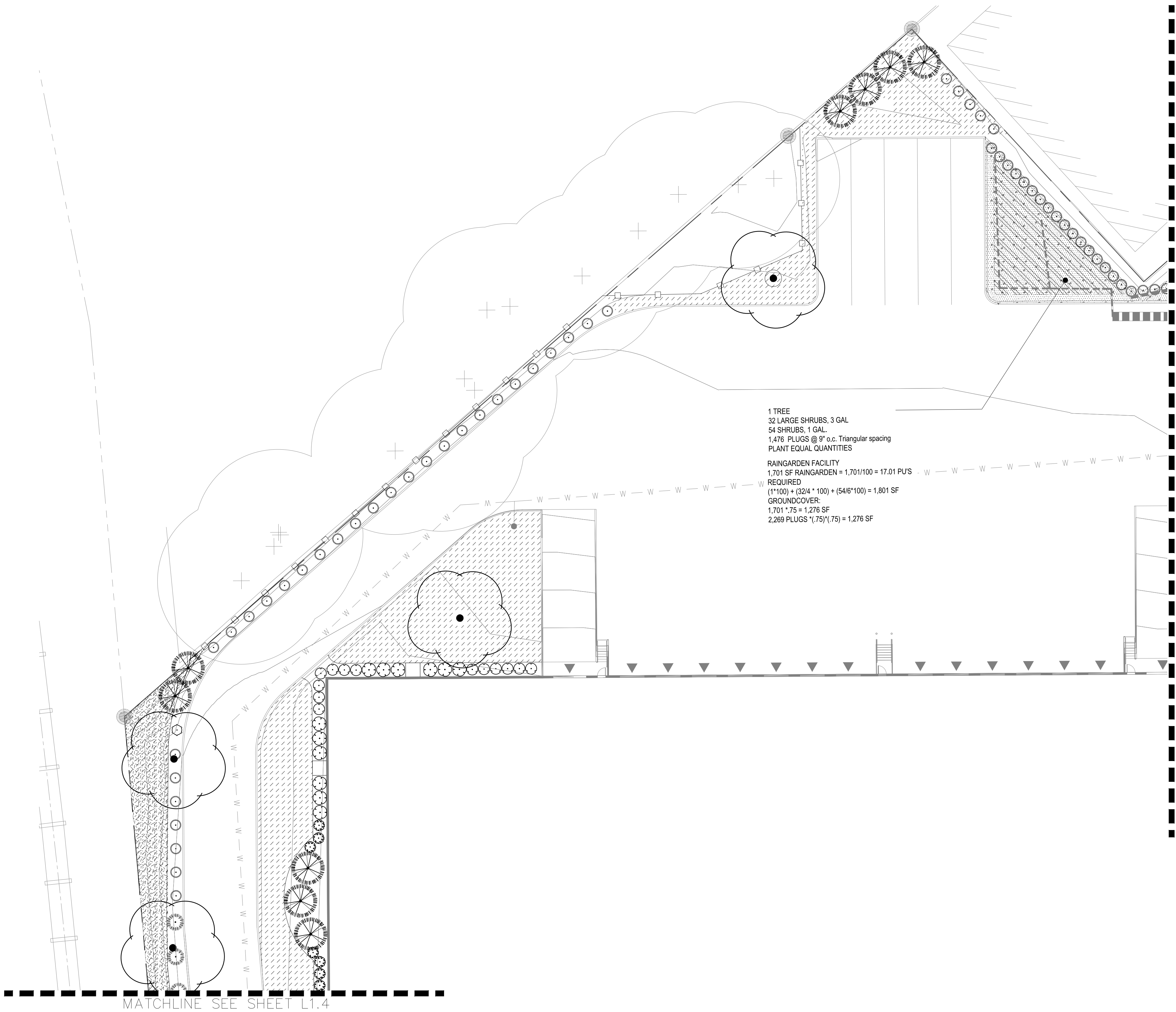

TREE PROTECTION FENCE

TREE PROTECTION FENCE

SEE SHEET L1.6 FOR PLANTING LEGEND

PLANTING NOTES

- ALL CONSTRUCTION SHALL BE PERFORMED IN ACCORDANCE WITH CURRENT CITY OF SALEM STANDARDS AND THE OREGON STRUCTURAL SPECIALTY CODE.
- CONTRACTOR SHALL CONTACT LANDSCAPE ARCHITECT AT LEAST TWO WEEKS PRIOR TO START OF LANDSCAPE WORK TO REVIEW PLANT SUBSTITUTIONS & JURISDICTIONAL REQUIREMENTS.
- SUBSTITUTIONS WILL NOT BE ACCEPTED UNLESS SPECIFICALLY ACCEPTED IN WRITING BY THE OWNER OR OWNER'S REPRESENTATIVE.
- VERIFY ALL EXISTING CONDITIONS, INCLUDING LOCATION OF PROPERTY LINES, PRIOR TO BEGINNING ANY WORK. REPORT ANY DISCREPANCIES TO THE OWNER'S REPRESENTATIVE IMMEDIATELY.
- DO NOT WILLFULLY PROCEED WITH CONSTRUCTION WHEN UNKNOWN OBSTRUCTIONS AND/OR DIFFERENCES EXIST THAT MAY NOT HAVE BEEN KNOWN DURING DESIGN. IMMEDIATELY NOTIFY OWNER'S REPRESENTATIVE OF UNKNOWN OBSTRUCTIONS AND/OR DIFFERENCES. PRIOR TO REMOVING ANY EXISTING FEATURES, REVIEW AND CONFIRM EXTENT OF DEMOLITION WITH OWNER'S REPRESENTATIVE.
- PROTECT EXISTING ITEMS TO REMAIN DURING CONSTRUCTION. ANY DAMAGE TO EXISTING ITEMS DESIGNATED TO REMAIN I.E. CURBS, WALKS, PLANT MATERIAL, LAWN OR FENCES SHALL BE REPAIRED OR REPLACED AT NO ADDITIONAL COST TO THE OWNER.
- VERIFY THE LOCATION OF ALL UNDERGROUND UTILITIES, LINES, PIPES, VAULTS, OR BOXES PRIOR TO EXCAVATION. MARK AND PROTECT ALL UTILITIES, SITE FEATURES AND VEGETATION TO REMAIN IN PLACE. ANY DAMAGE TO ANY KNOWN EXISTING UTILITY ELEMENTS SHALL BE REPAIRED PROPERLY AND IMMEDIATELY.
- REMOVE FROM THE SITE AND LEGALLY DISPOSE OF ALL DEBRIS AND EXCAVATED MATERIAL NOT REQUIRED FOR FILL. NO RUBBISH OR DEBRIS SHALL BE BURIED ON THE SITE.
- MAINTAIN ALL ROADWAYS AND PAVED PATHWAYS CLEAN AND FREE OF CONSTRUCTION MATERIALS AND DEBRIS, PROVIDING NECESSARY DUST CONTROL WHERE REQUIRED.
- COORDINATE AND SCHEDULE ALL WORK WITH THE OWNER'S REPRESENTATIVE.
- INSTALL EROSION CONTROL SYSTEMS IN ACCORDANCE WITH CITY OF SALEM STANDARDS PRIOR TO SITE WORK AND LANDSCAPE INSTALLATION.
- CONTRACTOR SHALL PROVIDE TOPSOIL, SOIL AMENDMENTS, AND EROSION CONTROL.
- CONTRACTOR SHALL SUBMIT CERTIFIED TOPSOIL ANALYSIS REPORT FOR OWNER'S APPROVAL PRIOR TO PLANT INSTALLATION. SEE SPECS.
- CONTRACTOR IS RESPONSIBLE FOR ANY AMENDMENTS TO SOIL PH FERTILITY AND/OR DRAINAGE CONDITIONS NECESSARY TO ENSURE PROPER GROWING CONDITIONS FOR PROPOSED PLANTINGS. SEE SPECS.
- CONTRACTOR SHALL FOLLOW PROVIDER'S INSTRUCTIONS AND RECOMMENDATIONS FOR SEEDING.
- ALL PLANTS SHALL BE IRRIGATED BY A FULLY AUTOMATED, PERMANENT IRRIGATION SYSTEM UNLESS OTHERWISE NOTED. SEE SPECS.
- PRIOR TO FINAL ACCEPTANCE, CONTRACTOR SHALL PROVIDE OWNER WITH AS-BUILT PLANS OF THE INSTALLATION, COPIES OF ALL OPERATION MANUALS AND WARRANTY DOCUMENTS.
- ALL NEW PLANTS IN LANDSCAPE AREAS SHALL BE WARRANTED FOR A PERIOD OF ONE YEAR FROM THE DATE OF FINAL ACCEPTANCE.
- COORDINATE INSTALLATION PLANTING MATERIALS WITH IRRIGATION. PLANT ONLY IN AREAS WHERE THE IRRIGATION SYSTEM IS COMPLETE AND FULLY OPERATIONAL.

PLANT HEALTH AND REPLACEMENT

- PROVIDE PLANT MATERIAL THAT IS HEALTHY NURSERY STOCK, WELL BRANCHED, AND FULL FOLIATED WHEN IN LEAF, AND FREE FROM DISEASE, INJURY, INSECTS, WEEDS AND WEED ROOTS.
- PLANT MATERIALS NOT MEETING SPECIFICATION REQUIREMENTS WILL BE REJECTED.

INITIAL INSPECTION OF PLANT MATERIAL

- ASSEMBLE ALL PLANTS FOR EACH INSPECTION AT ONE LOCATION FOR INSPECTION TO BE COMPLETED IN ONE VISIT. ANY FURTHER INSPECTION REQUIRED DUE TO PLANTS BEING UNAVAILABLE, REJECTED, AND OR NOT MEETING SPECIFICATIONS SHALL BE CHARGED TO THE CONTRACTOR AT THE CURRENT HOURLY RATE FOR THE LANDSCAPE ARCHITECT PERFORMING THE INSPECTION.
- OWNER RETAINS RIGHT TO OBSERVE TREES AND SHRUBS FURTHER FOR SIZE AND CONDITION OF BALLS AND ROOT SYSTEMS, INSECTS, INJURIES, AND LATENT DEFECTS AND TO REJECT UNSATISFACTORY OR DEFECTIVE MATERIAL AT ANY TIME DURING PROGRESS OF WORK.
- REMOVE REJECTED TREES OR SHRUBS FROM PROJECT SITE WITHIN 24 HOURS.
- REPLACE PLANT MATERIALS REJECTED BY OWNER AT NO ADDITIONAL EXPENSE TO OWNER.

PLANT LAYOUT AND INSPECTION

- ALL PLANTS SHALL BE INSTALLED ACCORDING TO AMERICAN STANDARD FOR NURSERY STOCK (ANSI Z60.1) AS WELL AS DETAIL DRAWINGS AND SPECIFICATIONS.
- LAYOUT OF MAJOR PLANTING AREAS AS INDICATED IN THE DRAWINGS ARE APPROXIMATE ONLY. OUTLINE IN THE FIELD LOCATIONS AND IDENTITY OF ALL TREES, SHRUBS AND GROUND COVERS, SUBJECT TO REVIEW AND APPROVAL.
- INSPECTION: NOTIFY THE OWNER 48 HOURS PRIOR TO BEGINNING PLANTING. THE OWNER MAY ADJUST PLANT MATERIAL LOCATION TO MEET FIELD CONDITIONS.
- DO NOT COMMENCE WITH PLANTING UNTIL OWNER HAS APPROVED THE LOCATION AND LAYOUT OF ALL PLANT BEDS.
- IF WORK IS NOT PROMPTLY OR PROPERLY PERFORMED BY THE CONTRACTOR, THE OWNER WILL, AT THEIR DISCRETION, HAVE THE WORK PERFORMED BY OTHERS. THE COST OF THE WORK BY OTHERS WILL BE DEDUCTED FROM THE CONTRACT AMOUNT.
- MULCH ALL SHRUBS AND GROUND COVER PLANTING BEDS WITH A 2 INCH LAYER OF IMPORTED MULCH MATERIAL WITHIN 2 DAYS AFTER PLANTING.
- COVER ENTIRE BED AREAS; APPLY EVENLY.

EDGING INSTALLATION

- SHOVEL-CUT EDGING: SEPARATE MULCHED AREAS FROM TURF AREAS, CURBS, AND PAVING WITH A 45 DEGREE, 4 TO 6 INCH DEEP, SHOVEL-CUT EDGE.

MAINTENANCE

1. MAINTAIN LANDSCAPE PLANTINGS FROM INSTALLATION UNTIL FINAL ACCEPTANCE.
- MAINTAIN TREES, SHRUBS, AND GROUND COVER BY TRIMMING, PRUNING, CULTIVATING, WATERING, WEEDING, FERTILIZING, RESTORING PLANTING SAUCERS, TIGHTENING AND REPAIRING STAKES AND GUY SUPPORTS, AND RESETTling TO PROPER GRADES OR VERTICAL POSITION, AS REQUIRED TO ESTABLISH HEALTHY, VIABLE PLANTINGS.
- WATER TREES BY DEEP ROOT WATERING METHOD.

WEEDING AND CLEANUP

- KEEP ALL LANDSCAPE AREAS CLEAN AND WEED FREE. KEEP ALL BUILDINGS, PAVEMENTS, AND OTHER EXTERIOR IMPROVEMENTS CLEAN AND FREE OF SOIL AND DEBRIS.
- WEED ALL BEDS WEEKLY.
- APPLY A 2 INCH LAYER OF MULCH MATERIAL TO SAUCER AREAS OF TREES AND SHRUBS LOCATED OUTSIDE OF PLANTING BEDS. PLACE MULCH NO CLOSER THAN 4 INCHES FROM TRUNKS OF WOODY PLANT MATERIAL AND AWAY FROM THE CROWNS OF HERBACEOUS PLANTS.

GRAPHIC SCALE



(IN FEET)

1 inch = 40 feet



DATE: 02/11/22

DRAWN: KPM

CHECKED: CNH

REVISIONS:

© AAI ENGINEERING INC.
2022. ALL RIGHTS RESERVED.

THESE DRAWINGS ARE THE
PROPERTY OF AAI ENGINEERING INC.
AND ARE NOT TO BE USED OR
REPRODUCED IN ANY MANNER
EXCEPT WITH THE PRIOR WRITTEN
PERMISSION OF AAI ENGINEERING INC.

SHEET NUMBER

L1.2

JOB NUMBER: A21166.10