

UPPER FLOOR PLAN
COBURN APARTMENT COMPLEX

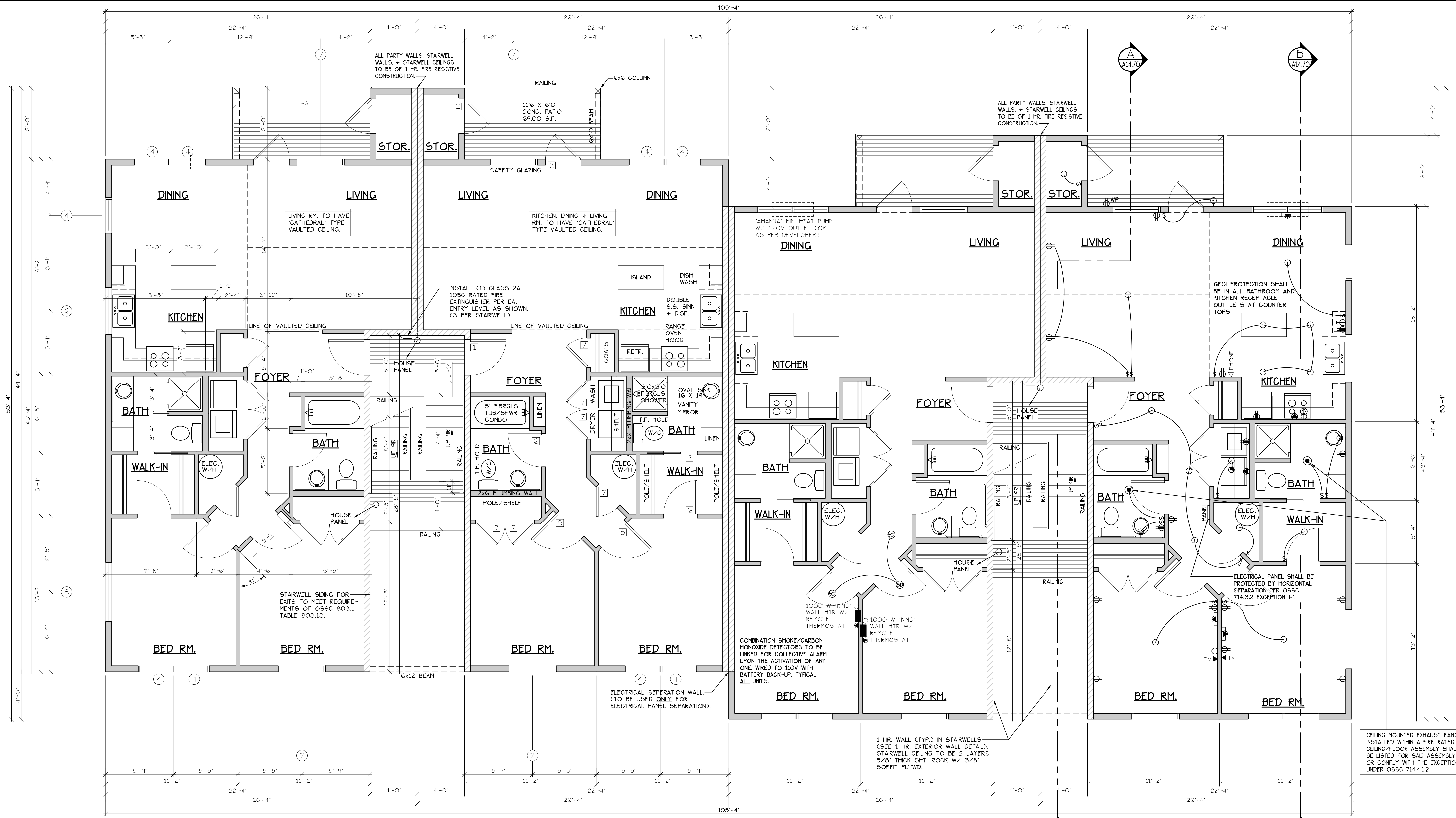

UPPER FLOOR PLAN
SCALE: 1/4" = 1'-0"
"G" UNIT = 1051 S.F.

TYPE G UNITS
BLD. 2.7.9-12+15

CONSTRUCTION TYPE V B SPRINKLED
SEE WALL DETAIL SHEETS FOR SHEETROCK APPLICATION.

- NOTES:**
1. ALL DOOR AND WINDOW HEADERS TO BE #2 4X12 UNLESS NOTED OTHERWISE ON PLANS.
 2. ALL 6X12 BEAMS SPECIFIED ON PLANS TO BE #1 D.F.
 3. ALL DOOR HEADERS (INCLUDING PATIO DOORS) TO BE FRAMED AT 6'-0" A.F.F. OR AS PER MFG. SPECIFICATIONS (SEE ELEVATIONS FOR ANY EXCEPTIONS).

(F) 907.2.10.3 SMOKE ALARMS, SINGLE AND MULTIPLE-STATION SMOKE ALARMS SHALL BE INSTALLED IN ACCORDANCE WITH SECTION 907.2.11.
(F) 907.2.11 SINGLE AND MULTIPLE-STATION SMOKE ALARMS, LISTED SINGLE AND MULTIPLE-STATION SMOKE ALARMS COMPLYING WITH UL 217 SHALL BE INSTALLED IN ACCORDANCE WITH SECTIONS 907.2.11.1 THROUGH 907.2.11.4 AND NFPA 72.

NOTE: ALL ACCESSIBLE DOORS SHALL BE PROVIDED WITH LEVER DOOR HARDWARE + OTHER OPERATING DEVICES IN COMPLIANCE WITH ICC/ANSI A117.1 SECTIONS 309.4, AND 404.2.G.

NOTE: MAX. U-VALUE FOR ALL WINDOWS AS PER TABLE 502.3 2014 IEESC U-0.35.

NOTE: WINDOW SILLS MORE THAN 72" ABOVE FINISH GRADE SHALL BE A MINIMUM OF 36" ABOVE FINISH FLOOR SURFACE (OR) BE INSTALLED WITH WINDOW OPENING CONTROL DEVICES IN COMPLIANCE WITH THE 2019 OSBC SECTIONS 1015.8.

DOOR SCHEDULE										
DOORS					FRAMES					REMARKS
ID	WIDTH	HEIGHT	THICK	TYP.	MATL.	FIN.	TYP.	MATL.	FIN.	
141	3'-0"	6'-8"	1-3/4"	MTL.	CLAD	FANT	A	METAL	FANT	6 PANEL 60 MIN RATED ASSY W/ THRESHOLD, WEATHERSTRIP, CLOSURES
142	3'-0"	6'-8"	1-3/4"	MTL.	CLAD	FANT	B	METAL	FANT	6 PANEL W/ THRESHOLD, WEATHERSTRIP AND KEYPED LOCK
143	3'-0"	6'-8"	1-3/4"	MTL.	CLAD	FANT	C	METAL	FANT	PULL-LITE, TEMP. GLASS, LOCK, THRESHOLD, WEATHERSTRIP AND INTERIOR BLINDS.
144	2'-6"	6'-8"	1-3/4"	MTL.	CLAD	FANT	D	METAL	FANT	W/ THRESHOLD, WEATHERSTRIP AND KEYPED LOCK
145	3'-0"	6'-8"	1-3/8"	H.C.	BIRCH	STAIN	E	HEMLOCK	STAIN	
146	2'-10"	6'-8"	1-3/8"	H.C.	BIRCH	STAIN	F	HEMLOCK	STAIN	
147	2'-6"	6'-8"	1-3/8"	H.C.	BIRCH	STAIN	G	HEMLOCK	STAIN	
148	2'-0"	6'-8"	1-3/8"	H.C.	BIRCH	STAIN	H	HEMLOCK	STAIN	
149	2'-10"	6'-8"	1-3/8"	H.C.	BIRCH	STAIN	I	HEMLOCK	STAIN	POCKET DOOR
150	2'-10"	6'-8"	1-3/8"	H.C.	BIRCH	STAIN	J	HEMLOCK	STAIN	POCKET DOOR
151	4'-0"	6'-8"	1-3/8"	H.C.	BIRCH	STAIN	K	HEMLOCK	STAIN	BI-PASS DOOR
152	5'-8"	6'-8"	1-3/8"	H.C.	BIRCH	STAIN	L	HEMLOCK	STAIN	BI-PASS DOOR
153	6'-0"	6'-8"	1-3/8"	H.C.	BIRCH	STAIN	M	HEMLOCK	STAIN	BI-PASS DOOR
154	4'-0"	6'-8"	1-3/8"	H.C.	BIRCH	STAIN	N	HEMLOCK	STAIN	BI-FOLD DOOR
155	5'-0"	6'-8"	1-3/8"	H.C.	BIRCH	STAIN	O	HEMLOCK	STAIN	BI-FOLD DOOR
156	6'-0"	6'-8"	1-3/8"	H.C.	BIRCH	STAIN	P	HEMLOCK	STAIN	BI-FOLD DOOR

* ACCESSIBLE POCKET DOORS MUST STOP FULLY OPEN WITH THEIR OPERATING HANDLES FULLY EXPOSED.

WINDOW SCHEDULE									
ID	SIZE	TYPE	MFG.	COLOR	NSUL	REMARKS	HEADERS		
1	2'0" X 1'6"	VINYL STAT.	MLGARD	WHITE	YES	STATIONARY - FROSTED	DF#1 4x12		
2	3'0" X 1'0"	VINYL STAT.	MLGARD	WHITE	YES	STATIONARY - FROSTED	DF#1 4x12		
3	3'0" X 1'6"	VINYL STAT.	MLGARD	WHITE	YES	STATIONARY - FROSTED	DF#1 4x12		
4	3'0" X 5'0"	VINYL SQH.	MLGARD	WHITE	YES	SINGLE HUNG W/ SCREEN	DF#1 6X8 (SEE 5'-0" TALL WINDOW FRAMING DETAIL A25.40)		
5	4'0" X 1'6"	VINYL STAT.	MLGARD	WHITE	YES	STATIONARY	DF#1 4x12		
6	4'0" X 3'6"	VINYL SLD.	MLGARD	WHITE	YES	HORIZ. SLIDER W/ SCREEN	DF#1 4x12		
7	4'0" X 5'0"	VINYL SQH.	MLGARD	WHITE	YES	SINGLE HUNG W/ SCREEN	DF#1 6X8 (SEE 5'-0" TALL WINDOW FRAMING DETAIL A25.40)		
8	5'0" X 1'6"	VINYL SLD.	MLGARD	WHITE	YES	STATIONARY	DF#1 4x12		
9	5'0" X 2'6"	VINYL SLD.	MLGARD	WHITE	YES	HORIZ. SLIDER W/ SCREEN	DF#1 4x12		
10	5'0" X 5'0"	VINYL SQH.	MLGARD	WHITE	YES	SINGLE HUNG W/ SCREEN	DF#1 6X8 (SEE 5'-0" TALL WINDOW FRAMING DETAIL A25.40)		
11	3'0" X 4'6"	CASEMENT	MLGARD	WHITE	YES	CASEMENT W/ SCREEN	DF#1 4x12		

NOTE: ALL LOWER FLOOR OPERABLE WINDOWS + HARDWARE TO COMPLY WITH O.S.S.C. 2019 CHAPTER 11 SEC. 1107.2 ON TO ICC/ANSI A117.1 THEN SEC. 1002.13. OPERABLE PARTS SHALL COMPLY WITH SEC. 309.4. SEE "OPERABLE WINDOWS IN ACCESSIBLE LOCATIONS" DETAIL ON SHEET ADA-5. ALL LOWER FLOOR WINDOW HEADERS TO BE SET AT 7'-0" A.F.F. U.N.O.

NOTE: FOR WINDOW PLACEMENT SEE "WINDOW PLACEMENT FOR EGRESS + FALL PROTECTION" DETAIL ON SHEET A25.40.

CONSTRUCTION TYPE V B SPRINKLED.

SEE "GENERAL STRUCTURAL NOTES" ON SHEET A14.20 BEFORE BEGINNING ANY CONSTRUCTION.

- GENERAL NOTES:**
1. ALL EXTERIOR WALLS TO BE 2 X 4 STUDS. ALL OTHER WALLS TO BE 2 X 4 STUDS UNLESS OTHERWISE NOTED.
 2. FIRE BLOCK CONCEALED SPACES (VERTICAL + HORIZONTAL) AS PER OSBC 718.2.2 AND OSBC 718.2.3.
 3. PRIOR TO INSTALLATION OF FIBERGLASS TUB/SOWER + SHOWER UNITS, SHEET ROCK SHALL BE APPLIED TO STUD WALLS AS INDICATED ON PLANS.
 4. ALL BATH FANS TO HAVE MIN. 80 CFM. RANGE HOOD EXHAUST FANS TO HAVE MIN. 150 CFM.
 5. ELECTRIC OUTLETS IN 1 HR. WALL MAY NOT BE BACK TO BACK AND MUST BE SEPARATED BY HORIZONTAL DISTANCE OF 2'-0".
 6. ALL EXTERIOR FLOOD LIGHTING SHALL BE CONNECTED TO HOUSE PANELS LOCATED IN ON-SITE UTILITY ROOMS + STORAGE BLD'S.
 7. AS PER OSBC HIGH-EFFICIENCY LIGHTING SYSTEMS - A MINIMUM OF 50 PERCENT OF THE LAMPS IN PERMANENTLY INSTALLED LIGHTING FIXTURES SHALL BE COMPACT OR LINEAR FLUORESCENT, OR A LIGHTING SOURCE THAT HAS A MINIMUM EFFICACY OF 40 LUMENS PER INPUT WATT.
 8. ALL "TYPE A" ACCESSIBLE UNITS REQUIRE THE PATIO TO BE AT SAME LEVEL AS DWELLING UNIT.

NO CHANGES, MODIFICATIONS OR REVISIONS TO BE MADE TO THIS DRAWING WITHOUT AUTHORIZATION FROM THE DESIGN ENGINEER.
DIMENSIONS & NOTES TAKE PRECEDENCE OVER GRAPHICAL REPRESENTATION.

Design: P.L.M. / A.S.5018
Drawn: G.L.D.
Checked: M.D.G.
Date: Jun-21
Scale: AS SHOWN
JOB # 7192
Professional Engineer Seal: Mark D. Seeley, No. 10000, State of Oregon, Expires 12/31/2023

A8.50