

MAIN FLOOR PLAN

COBURN APARTMENT COMPLEX

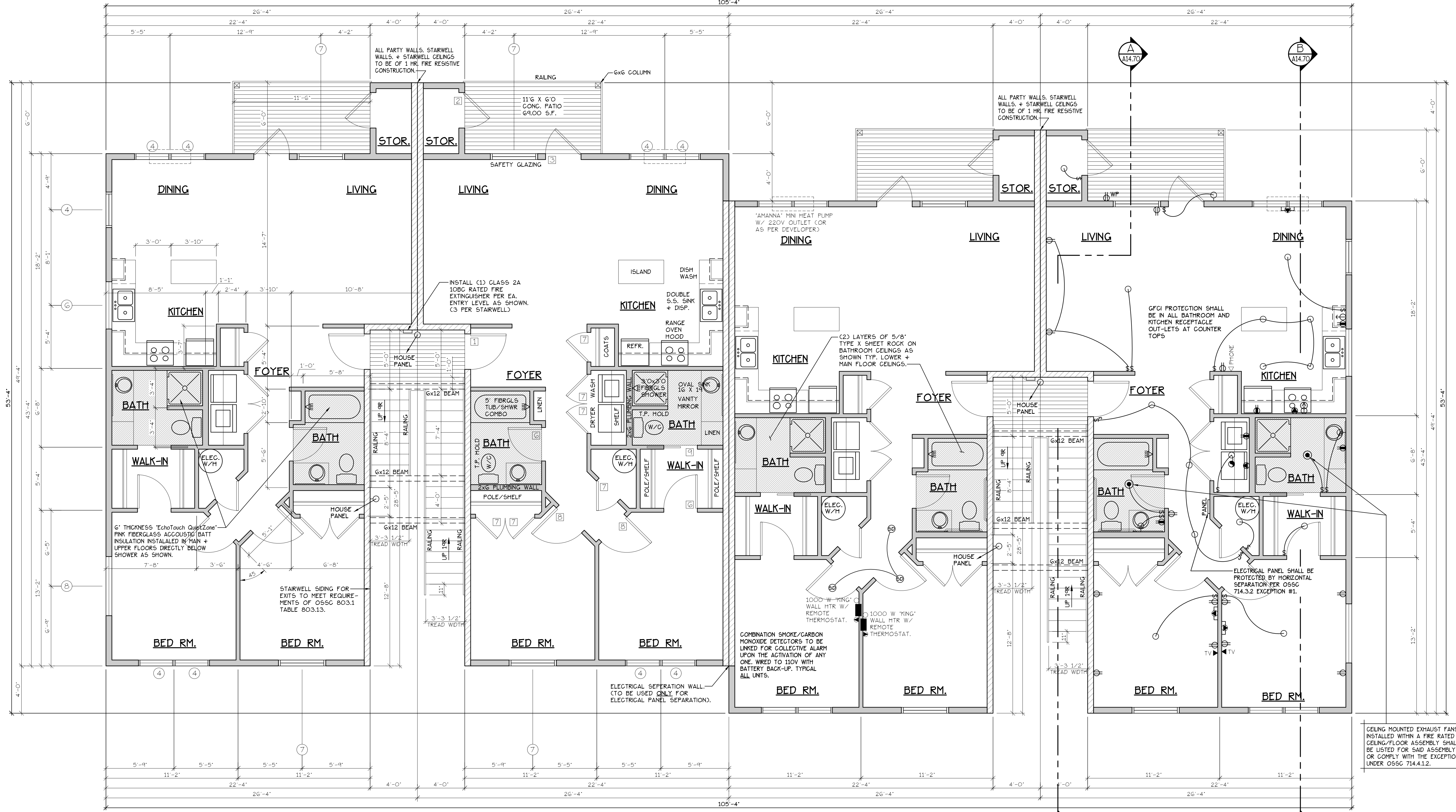

MAIN FLOOR PLAN
SCALE: 1/4" = 1'-0"
"G" UNIT = 1051 S.F.

TYPE G UNITS
BLD. 2,7,9-12+15

CONSTRUCTION TYPE V B SPRINKLED
SEE WALL DETAIL SHEETS FOR SHEETROCK APPLICATION.

DOOR SCHEDULE											
DOORS				FRAMES				REMARKS			
ID	WIDTH	HEIGHT	THICK	TYP.	MATL.	FIN.	TYP.	MATL.	FIN.	TYP.	REMARKS
141	3'-0"	6'-8"	1-3/4"	MTL.	CLAD	PAINT	A	METAL	PAINT	G	6" PANEL 60 MIN RATED ASSY. W/ THRESHOLD, WEATHERSTRIP, CLOSURES.
142	3'-0"	6'-8"	1-3/4"	MTL.	CLAD	PAINT	B	METAL	PAINT	G	6" PANEL W/ THRESHOLD, WEATHERSTRIP AND KEYPAD LOCK
143	3'-0"	6'-8"	1-3/4"	MTL.	CLAD	PAINT	C	METAL	PAINT	G	FULL LITE, TEMP. GLASS, LOCK, THRESHOLD, WEATHERSTRIP AND INTERIOR BLINDS.
144	2'-6"	6'-8"	1-3/4"	MTL.	CLAD	PAINT	D	METAL	PAINT	G	W/ THRESHOLD, WEATHERSTRIP AND KEYPAD LOCK
145	3'-0"	6'-8"	1-3/8"	H.C.	BIRCH	STAIN	E	HEMLOCK	STAIN	G	
146	2'-10"	6'-8"	1-3/8"	H.C.	BIRCH	STAIN	E	HEMLOCK	STAIN	G	
147	2'-6"	6'-8"	1-3/8"	H.C.	BIRCH	STAIN	E	HEMLOCK	STAIN	G	
148	2'-0"	6'-8"	1-3/8"	H.C.	BIRCH	STAIN	E	HEMLOCK	STAIN	G	
149	2'-10"	6'-8"	1-3/8"	H.C.	BIRCH	STAIN	F	HEMLOCK	STAIN	G	POCKET DOOR
150	2'-10"	6'-8"	1-3/8"	H.C.	BIRCH	STAIN	F	HEMLOCK	STAIN	G	POCKET DOOR
151	4'-0"	6'-8"	1-3/8"	H.C.	BIRCH	STAIN	G	HEMLOCK	STAIN	G	BI-PASS DOOR
152	5'-8"	6'-8"	1-3/8"	H.C.	BIRCH	STAIN	G	HEMLOCK	STAIN	G	BI-PASS DOOR
153	6'-0"	6'-8"	1-3/8"	H.C.	BIRCH	STAIN	G	HEMLOCK	STAIN	G	BI-PASS DOOR
154	4'-0"	6'-8"	1-3/8"	H.C.	BIRCH	STAIN	H	HEMLOCK	STAIN	G	BI-FOLD DOOR
155	5'-0"	6'-8"	1-3/8"	H.C.	BIRCH	STAIN	H	HEMLOCK	STAIN	G	BI-FOLD DOOR
156	6'-0"	6'-8"	1-3/8"	H.C.	BIRCH	STAIN	H	HEMLOCK	STAIN	G	BI-FOLD DOOR

WINDOW SCHEDULE											
ID	SIZE	TYPE	MFG.	COLOR	INSUL.	REMARKS	HEADERS				
1	2'0" X 1'6"	VNLT STAT.	MILGARD	WHITE	YES	STATIONARY - FROSTED	DF#1 4x12				
2	3'0" X 1'0"	VNLT STAT.	MILGARD	WHITE	YES	STATIONARY - FROSTED	DF#1 4x12				
3	3'0" X 1'6"	VNLT STAT.	MILGARD	WHITE	YES	STATIONARY - FROSTED	DF#1 4x12				
4	3'0" X 5'0"	VNLT SQH.	MILGARD	WHITE	YES	SINGLE HUNG W/ SCREEN	DF#1 6x8 (SEE 5'-0" TALL WINDOW FRAMING DETAIL A25.40)				
5	4'0" X 1'6"	VNLT STAT.	MILGARD	WHITE	YES	STATIONARY	DF#1 4x12				
6	4'0" X 3'6"	VNLT SLD.	MILGARD	WHITE	YES	HORIZ. SLIDER W/ SCREEN	DF#1 4x12				
7	4'0" X 5'0"	VNLT SQH.	MILGARD	WHITE	YES	SINGLE HUNG W/ SCREEN	DF#1 6x8 (SEE 5'-0" TALL WINDOW FRAMING DETAIL A25.40)				
8	5'0" X 1'6"	VNLT STAT.	MILGARD	WHITE	YES	STATIONARY	DF#1 4x12				
9	5'0" X 2'6"	VNLT SLD.	MILGARD	WHITE	YES	HORIZ. SLIDER W/ SCREEN	DF#1 4x12				
10	5'0" X 5'0"	VNLT SQH.	MILGARD	WHITE	YES	SINGLE HUNG W/ SCREEN	DF#1 6x8 (SEE 5'-0" TALL WINDOW FRAMING DETAIL A25.40)				
11	3'0" X 4'6"	CASEMENT	MILGARD	WHITE	YES	CASEMENT W/ SCREEN	DF#1 4x12				

NOTE: ALL LOWER FLOOR OPERABLE WINDOWS + HARDWARE TO COMPLY WITH O.S.S.C. 2019 CHAPTER 11 SEC. 1107.2 ON TO ICC/ANSI A117.1 THEN SEC. 1002.13. OPERABLE PARTS SHALL COMPLY WITH SEC. 309.4. SEE "OPERABLE WINDOWS IN ACCESSIBLE LOCATIONS" DETAIL ON SHEET ADA-5. ALL LOWER FLOOR WINDOW HEADERS TO BE SET AT 7'-0" A.F.F. U.N.O.

CADET HEATING + SMOKE/CARBON MONOXIDE DETECTORS

NOTES:
1. ALL DOOR AND WINDOW HEADERS TO BE #2 4x12 UNLESS NOTED OTHERWISE ON PLANS.
2. ALL 6x12 BEAMS SPECIFIED ON PLANS TO BE #1 D.F.
3. ALL DOOR HEADERS (INCLUDING PATIO DOORS) TO BE FRAMED AT 6'-9" A.F.F. OR AS PER MFG. SPECIFICATIONS (SEE ELEVATIONS FOR ANY EXCEPTIONS).

(F) 907.2.10.3 SMOKE ALARMS, SINGLE AND MULTIPLE-STATION SMOKE ALARMS SHALL BE INSTALLED IN ACCORDANCE WITH SECTION 907.2.11.
(F) 907.2.11 SINGLE AND MULTIPLE-STATION SMOKE ALARMS, LISTED SINGLE AND MULTIPLE-STATION SMOKE ALARMS COMPLYING WITH UL 217 SHALL BE INSTALLED IN ACCORDANCE WITH SECTIONS 907.2.11.1 THROUGH 907.2.11.4 AND NFPA 72.
NOTE: ALL ACCESSIBLE DOORS SHALL BE PROVIDED WITH LEVER DOOR HARDWARE + OTHER OPERATING DEVICES IN COMPLIANCE WITH ICC/ANSI A117.1 SECTIONS 309.4, AND 404.2.G.
NOTE: MAX. U-VALUE FOR ALL WINDOWS AS PER TABLE 502.3 2014 OESG U-0.35.
NOTE: WINDOW SILLS MORE THAN 72" ABOVE FINISH GRADE SHALL BE A MINIMUM OF 36" ABOVE FINISH FLOOR SURFACE (OR) BE INSTALLED WITH WINDOW OPENING CONTROL DEVICES IN COMPLIANCE WITH THE 2019 OESG SECTIONS 1015.8.

CONSTRUCTION TYPE V B SPRINKLED.

ELECTRICAL ○ = HEATER/LIGHT/FAN

SEE "GENERAL STRUCTURAL NOTES" ON SHEET A14.20 BEFORE BEGINNING ANY CONSTRUCTION.

GENERAL NOTES:
1. ALL EXTERIOR WALLS TO BE 2 X 6 STUDS. ALL OTHER WALLS TO BE 2 X 4 STUDS UNLESS OTHERWISE NOTED.
2. FIRE BLOCK CONCEALED SPACES (VERTICAL + HORIZONTAL) AS PER OESG 718.2.2 AND OESG 718.2.3.
3. PRIOR TO INSTALLATION OF FIBERGLASS TUB/SOWER + SHOWER UNITS, SHEET ROCK SHALL BE APPLIED TO STUD WALLS AS INDICATED ON PLANS.
4. ALL BATH FANS TO HAVE MIN. 80 CFM RANGE HOOD EXHAUST FANS TO HAVE MIN. 150 CFM.
5. ELECTRIC OUTLETS IN 1 HR. WALL MAY NOT BE BACK TO BACK AND MUST BE SEPARATED BY HORIZONTAL DISTANCE OF 2'-0".
6. ALL EXTERIOR FLOOD LIGHTING SHALL BE CONNECTED TO HOUSE PANELS LOCATED IN ON-SITE UTILITY ROOMS + STORAGE BLD'S.
7. AS PER OESG HIGH-EFFICIENCY LIGHTING SYSTEMS - A MINIMUM OF 50 PERCENT OF THE LAMPS IN PERMANENTLY INSTALLED LIGHTING FIXTURES SHALL BE COMPACT OR LINEAR FLUORESCENT, OR A LIGHTING SOURCE THAT HAS A MINIMUM EFFICACY OF 40 LUMENS PER INPUT WATT.
8. ALL "TYPE A" ACCESSIBLE UNITS REQUIRE THE PATIO TO BE AT SAME LEVEL AS DWELLING UNIT.

NO CHANGES, MODIFICATIONS OR REVISIONS TO BE MADE TO THIS DRAWING WITHOUT AUTHORIZATION FROM THE DESIGN ENGINEER.
DIMENSIONS & NOTES TAKE PRECEDENCE OVER GRAPHICAL REPRESENTATION.

Design: P.L.M. / A.B. HUNTER
Drawn: G.L.D.
Checked: M.D.G.
Date: Jun-21
Scale: AS SHOWN
JOB # 7192

