

G:\PDX\_Projects\19\2629 - Salem Improvements To ASR\CAD\Permit Set\19-2629-OR-TF-C-Permit.dwg TF-C-5 8/3/2020 3:55 PM LEA.CONNORS 23.0s (LMS Tech)

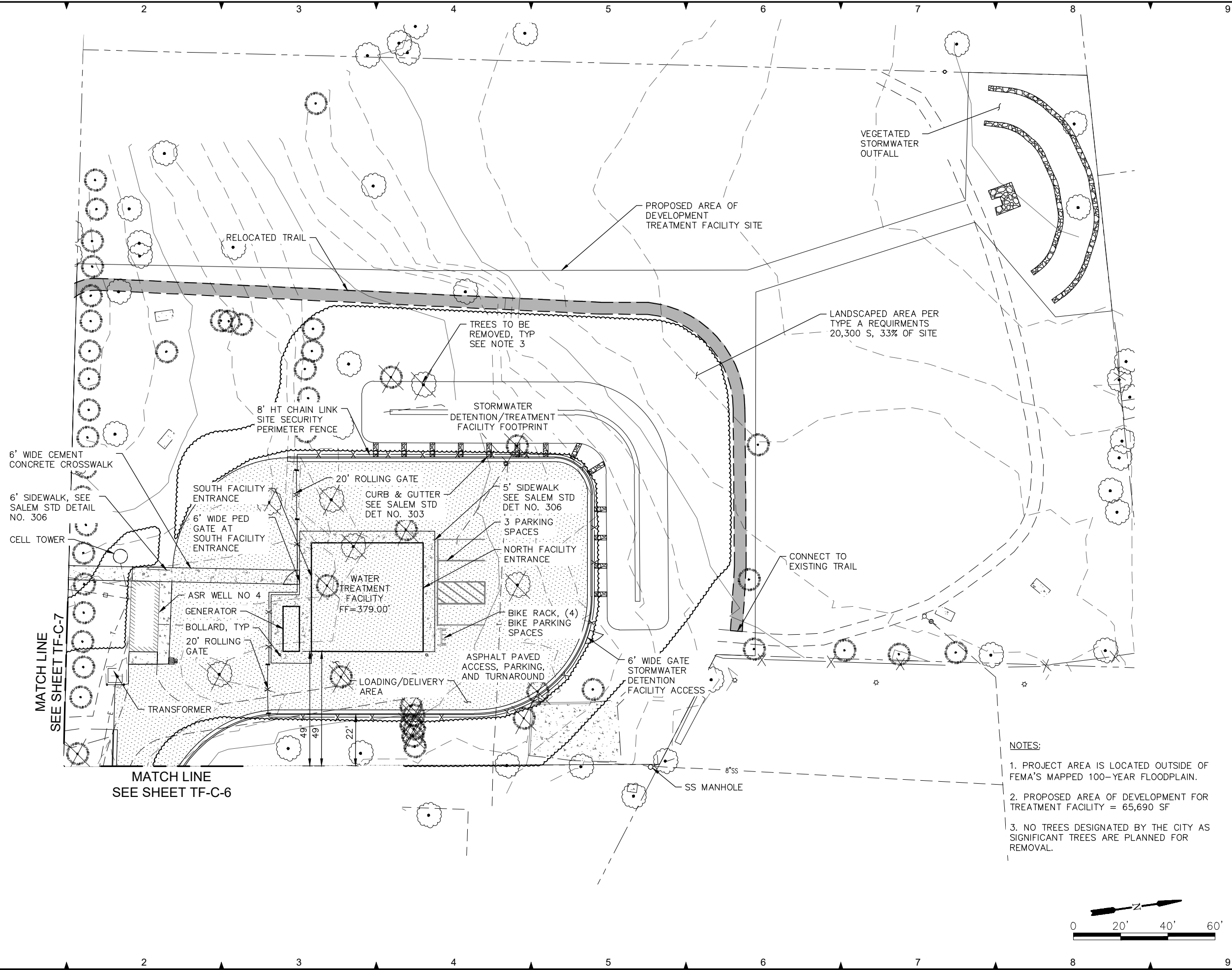

- NOTES:
1. PROJECT AREA IS LOCATED OUTSIDE OF FEMA'S MAPPED 100-YEAR FLOODPLAIN.
  2. PROPOSED AREA OF DEVELOPMENT FOR TREATMENT FACILITY = 65,690 SF
  3. NO TREES DESIGNATED BY THE CITY AS SIGNIFICANT TREES ARE PLANNED FOR REMOVAL.



SHEET PREPARED BY:

**murraysmith**

888 SW 5TH AVENUE, SUITE 1170  
PORTLAND, OREGON 97204  
P 503.225.9010

**PERMIT  
REVIEW SET  
REVISED 8/3/2020**

**PRELIMINARY ONLY**  
DO NOT USE FOR CONSTRUCTION

JULY 2020

**Murraysmith**  
www.murraysmith.us

SIGNED:

**IMPROVEMENTS TO THE AQUIFER  
STORAGE AND RECOVERY  
FACILITY**

REVISIONS			
NO.	DESCRIPTION	DATE	BY

**PN:XXXXXX**

HORIZ DATUM: NAD 83-SPCS  
VERT DATUM: NGVD 1929 (47)  
HORIZ SCALE: AS SHOWN  
VERT SCALE:      

DESIGN: LRC  
DRAWN: CAD  
CHECKED: XXX

APPROVED: XXX

SHEET TITLE

**SCHEDULE A  
TREATMENT FACILITY  
SITE LAYOUT PLAN**

**TF-C-5**

SHEET ---- OF

***murraysmith*** 

**PERMIT  
REVIEW SET  
REVISED 8/3/2020**

**Murraysmith**  
www.murraysmith.us

## IMPROVEMENTS TO THE AQUIFER STORAGE AND RECOVERY FACILITY

REVISIONS			
NO.	DESCRIPTION	DATE	BY

PN:XXXXXX

DESIGN:	LRC
DRAWN:	CAD
CHECKED:	XXX

SHEET TITLE

SCHEDULE A  
TREATMENT FACILITY  
PED CONNECTION  
LAYOUT PLAN

**TF-C-7**

SHEET ---- OF

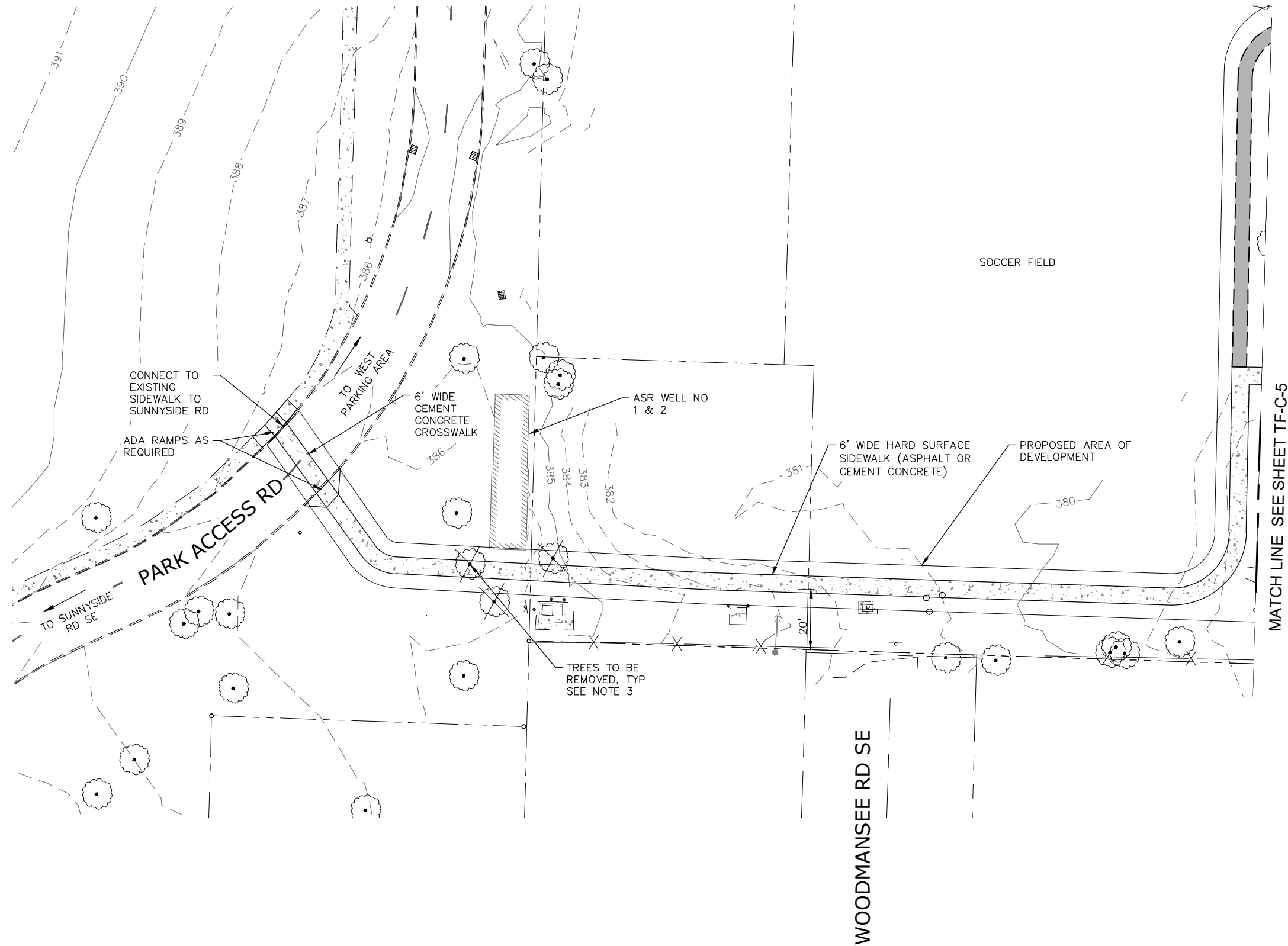

1. PROJECT AREA IS LOCATED OUTSIDE OF FEMA'S MAPPED 100-YEAR FLOODPLAIN.
2. PROPOSED AREA OF PEDESTRIAN ACCESS CONCEPT = 8,980 SF
3. NO TREES DESIGNATED BY THE CITY AS SIGNIFICANT TREES ARE PLANNED FOR REMOVAL.

