

This document, together with the concepts and designs presented herein, as an instrument of service, is intended only for the specific purpose and client for which it was prepared. Reuse of and improper reliance on this document without written authorization and adaptation by Kimley-Horn and Associates, Inc. shall be without liability to Kimley-Horn and Associates, Inc.

THIS PLAN SET IS BASED ON AUTOCAD FILES OBTAINED BY KIMLEY-HORN AND ASSOCIATES, INC. FROM PEPSICO, INC.

DRAWING RECEIVED ON: OCTOBER 11, 2023

THE CONTRACTOR IS SPECIFICALLY CAUTIONED THAT THE EXISTING INFORMATION SHOWN ON THESE PLANS IS NOT TO BE RELIED ON AS BEING EXACT OR COMPLETE. THE CONTRACTOR WILL BE RESPONSIBLE FOR FIELD VERIFYING EXISTING SITE CONDITIONS BEFORE COMMENCING CONSTRUCTION. THE CONTRACTOR MUST ALSO CALL 811 AT LEAST 72 HOURS BEFORE ANY EXCAVATION TO REQUEST EXACT FIELD LOCATION OF UTILITIES.

EXISTING CONDITIONS LEGEND

PROPERTY LINE

EXISTING GALVANIZED CHAIN LINK FENCE

SITE SUMMARY		
TOTAL LOT AREA	1.81 AC	
EXISTING ACCESSIBLE PARKING SPACES REQUIRED	1 SPACE	
EXISTING ACCESSIBLE PARKING SPACES PROVIDED	1 SPACE	
EXISTING EMPLOYEE PARKING SPACES PROVIDED	22 SPACES	
EXISTING BULK/BOX TRUCK PARKING SPACES PROVIDED	41 SPACES	
EXISTING TRAILER PARKING/DOCK SPACES PROVIDED	9 SPACES	
EXISTING BICYCLE PARKING SPACES	0 SPACES	

NORTH

GRAPHIC SCALE IN FEET

0102040

SCALED FOR 'D' SIZE (24"x36") PLANS ONLY ANY OTHER PLAN SIZE MAY NOT BE TO SCALE

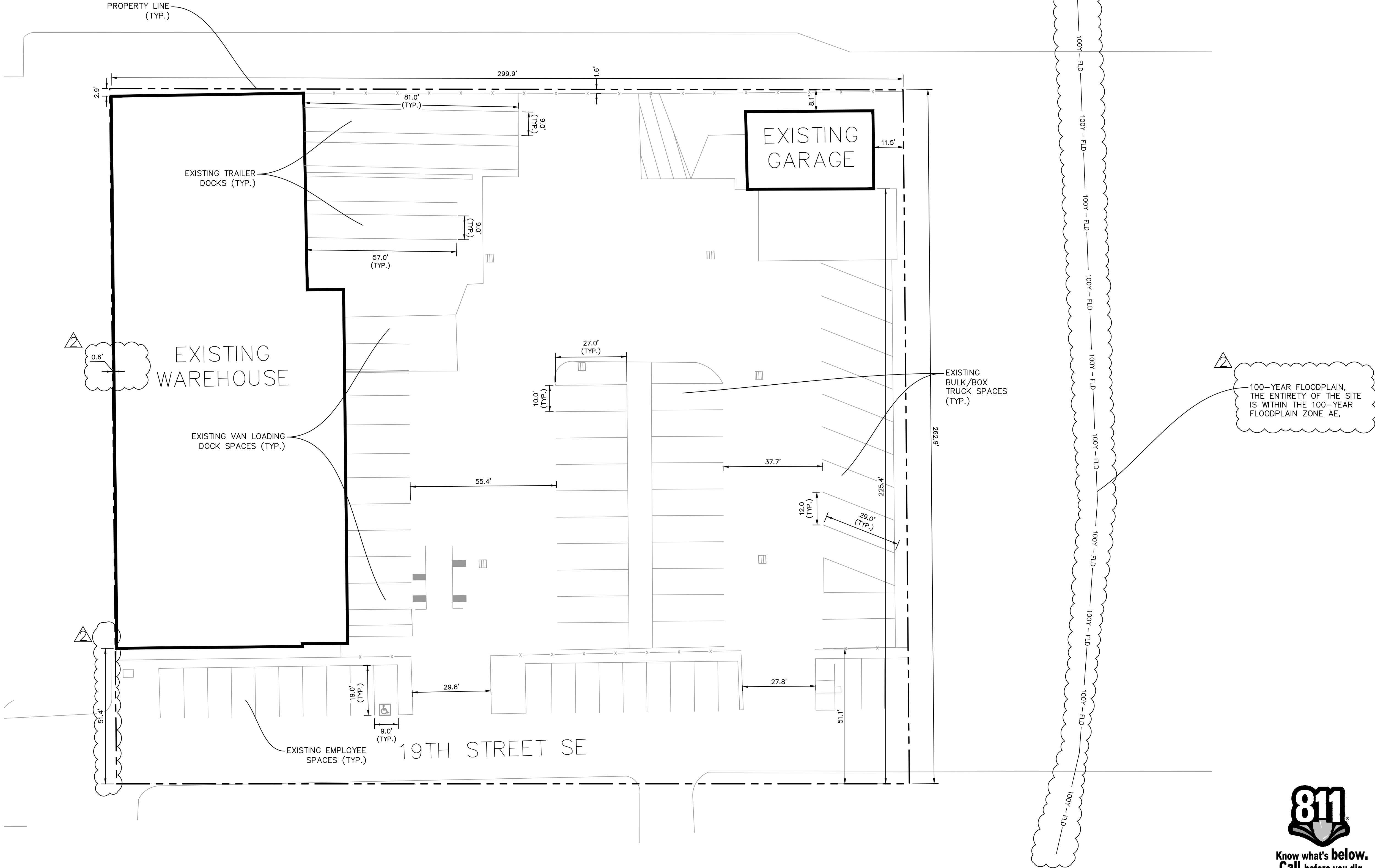

FRITO-LAY

2711 19th STREET SE

SALEM, OR 97302-1503

EXISTING CONDITIONS

KHA PROJECT

268548019

DATE

04/01/2024

SCALE AS SHOWN

DESIGNED BY CLD

DRAWN BY CLD

CHECKED BY WAD

Kimley»Horn

© 2024 KIMLEY-HORN AND ASSOCIATES, INC.
1 SOUTHWEST COLUMBIA ST, SUITE 650, PORTLAND, OR 97204
WWW.KIMLEY-HORN.COM

ROUND 1 COMMENTS

08/13/24 CLK

CLASS 2 SITE PLAN REVIEW

06/29/24 CLD

1

2

NO.

NO.

NO.

NO.

NO.

NO.

REVISIONS

DATE

BY