

New Storm Catch Basin to be installed. Hard piped to Storm Main in Commercial St NE with 4" PVC

Existing Storm Main in Commercial St NE

Proposed Elevations

Some elevations are already existing (see existing conditions plan)

1/4" minus compacted gravel of at least 4" depth in all vehicle use areas; with at least 3" of asphalt overlay will be used as a base for the driveway. The parking area is to be overlaid with pervious pavers. The ADA parking space and offload area is to be overlaid at least 4" of concrete.

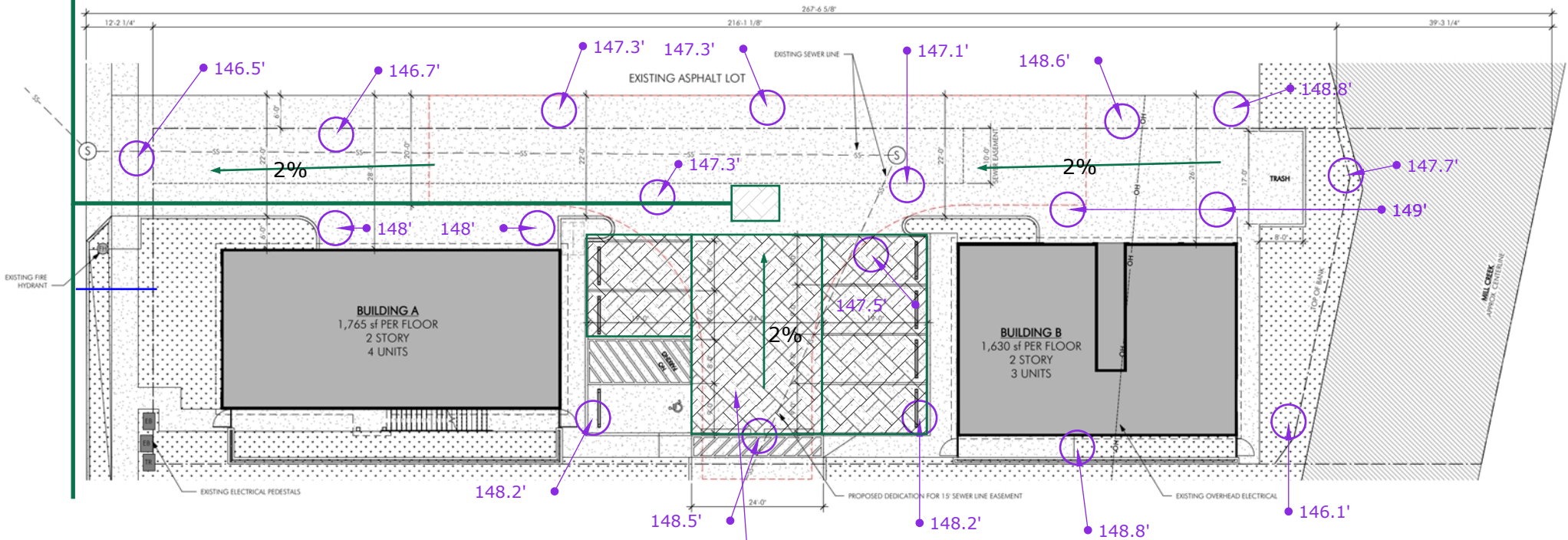

 Basketweave patterned area in parking lot to be commercial pavers. ADA parking and offload to be poured concrete with broom finish.

