

This document, together with the concepts and designs presented herein, as an instrument of service, is intended only for the specific purpose and client for which it was prepared. Reuse of and improper reliance on this document without written authorization and adaptation by Kimley-Horn and Associates, Inc. shall be without liability to Kimley-Horn and Associates, Inc.

PROPOSED PAVING IMPROVEMENTS

(DETAIL)  
DETAIL REFERENCE (SEE APPROPRIATE DETAIL SHEET)

ASPHALT IMPROVEMENTS

CRACK SEAL  
6.0" CUT AND PATCH  
6.0" REMOVE AND REPLACE

CONCRETE IMPROVEMENTS

REMOVE ASPHALT AND REPLACE WITH CONCRETE PAVEMENT

TOTAL ESTIMATED QUANTITIES

ASPHALT IMPROVEMENTS

CRACK SEAL 1 LS  
6.0" CUT AND PATCH 58 SY  
6.0" REMOVE AND REPLACE 2,360 SY

CONCRETE IMPROVEMENTS

REMOVE ASPHALT AND REPLACE WITH CONCRETE PAVEMENT 435 SF

MISCELLANEOUS IMPROVEMENTS

REMOVE AND REINSTALL GATE LOOP DETECTOR 2 EA  
SUBGRADE/AGGREGATE BASE UNDERCUT (ALLOWANCE) 3 CY  
RESTRIPE/SITE PAINT (DISTURBED AREAS ONLY) 1 LS  
LICENSED MATERIALS TESTING AGENCY 1 LS

**\*\* CONTRACTOR TO NOTE THAT ALL PRICING FOR ALTERNATES SHALL INCLUDE RESTRIPING AND MATERIALS TESTING IN THE PROVIDED UNIT COSTS FOR EACH SEPARATE ALTERNATE. THE CONTRACTOR WILL BE REQUIRED TO PROVIDE MATERIALS TESTING AND RESTRIPING AT PROVIDED COSTS AND NO CHANGES TO THE CONTRACT WILL BE APPROVED FOR TESTING OR STRIPING IN THE EVENT IT IS NOT INCLUDED IN ALTERNATE UNIT COSTS. \*\***

NOTE: QUANTITIES PROVIDED ABOVE ARE FOR REFERENCE ONLY TO ASSIST THE CONTRACTOR IN BIDDING. KIMLEY-HORN AND ASSOCIATES, INC. PROVIDES NO GUARANTEE TO THE ACCURACY OF THE ESTIMATED QUANTITIES LISTED. IT WILL BE THE RESPONSIBILITY OF THE CONTRACTOR TO FIELD VERIFY WORK AREAS AND IMPROVEMENTS SHOWN AND COMPLETE THE ENTIRE SCOPE OF WORK AT NO INCREASE IN LUMP SUM PRICE. CONTRACTOR SHALL COMPLETE ALL WORK WITHIN THE DEFINED WORK AREAS PER DRAWINGS AND SPECIFICATIONS UNLESS OTHERWISE IDENTIFIED ON THE PLANS AS ALLOWANCE ITEMS.

AP-CS

AP-CS TYPICAL NOTE:

ALL CRACKS GREATER THAN 1/4" IN CRACK SEAL AREAS DESIGNATED ON THE PLANS SHALL BE FILLED. CRACK SEALING WILL BE IN ACCORDANCE WITH THE AP-CS DETAILS IN THE PLAN SET, AND WILL BE GOVERNED BY THE THICKNESS OF THE EXISTING CRACK. STRAIGHT LINE CRACKS SUCH AS THOSE CAUSED BY PAVING JOINT SEAMS SHALL BE ROUTED PRIOR TO BLOWING OUT.

SITE SUMMARY

ZONING: IG - GENERAL INDUSTRIAL  
EXISTING WAREHOUSE 14,559 SF  
TOTAL SITE AREA 1.81 AC  
ACCESSIBLE PARKING SPACES REQUIRED 1 SPACE  
ACCESSIBLE PARKING SPACES PROVIDED 1 SPACE  
EMPLOYEE PARKING SPACES PROVIDED 22 SPACES  
BULK/BOX TRUCK PARKING SPACES PROVIDED 41 SPACES  
TRAILER PARKING/DOCK SPACES PROVIDED 9 SPACES

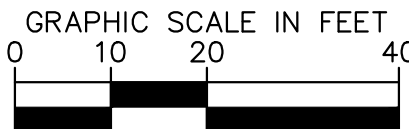

SCALED FOR 11" SIZE (24"x36") PLANS ONLY  
ANY OTHER PLAN SIZE MAY NOT BE TO SCALE

GENERAL NOTES

1. INSTALL SILTSACK OR APPROVED EQUAL INLET FILTER AT STORM SEWER INLET (TYP.) FOR ALL INLETS WITHIN OR DOWNSTREAM OF PAVEMENT REPAIR AREAS. SEE DETAIL.
2. CONTRACTOR SHALL PHASE WORK SO THAT CUSTOMER ACCESS TO BUILDING ENTRANCES REMAIN OPEN AT ALL TIMES.
3. CONTRACTOR TO LOCATE ALL PRIVATE AND PUBLIC UTILITIES ON SITE WITHIN WORK AREAS. CONTRACTOR TO TAKE EXTRA CAUTION TO AVOID DAMAGE TO ELECTRICAL, TELEPHONE, IRRIGATION, AND OTHER CONDUITS TYPICALLY FOUND IN THE UPPER FEW FEET OF GROUND. CONTRACTOR SHALL REPLACE ANY DAMAGED OR DESTROYED UTILITIES AT NO ADDITIONAL COST TO THE OWNER.
4. CONTRACTOR TO REMOVE TREE ROOTS AS NECESSARY TO PERFORM REPAIRS INDICATED. WHEN ROOT CUTTING IS UNAVOIDABLE, A CLEAN SHARP CUT SHALL BE MADE TO AVOID SHREDDING OR SMASHING. ROOT CUTS SHOULD BE MADE BACK TO A LATERAL ROOT. WHENEVER POSSIBLE, TREE ROOTS SHOULD BE CUT BETWEEN LATE FALL AND BUD OPENING. WHEN ROOT ENERGY SUPPLIES ARE HIGH AND CONDITIONS ARE LEAST FAVORABLE FOR DISEASE CAUSING AGENTS, EXPOSED ROOTS SHALL BE COVERED IMMEDIATELY TO PREVENT DEHYDRATION. ROOTS SHALL BE COVERED WITH SOIL OR BURLAP AND KEPT MOIST.
5. PAVEMENT CORES HAVE BEEN OBTAINED FOR THE ENGINEER'S AND OWNER'S USE AND ARE AVAILABLE TO THE CONTRACTOR TO USE TO THE EXTENT THEY FEEL ARE SUFFICIENT. THE CONTRACTOR IS CAUTIONED THAT PAVEMENT AND OTHER MATERIAL THICKNESS MAY VARY BETWEEN ACTUAL CORE LOCATIONS. THE CONTRACTOR IS ENCOURAGED TO PERFORM THEIR OWN INVESTIGATION PRIOR TO BIDDING IN ORDER TO MEET THE INTENT OF THE PLANS AND SPECIFICATIONS. THERE WILL BE NO EXTRAS FOR VARIANCE BETWEEN CORES MADE AVAILABLE TO THE CONTRACTOR.
6. ALL PAVEMENT REPLACED ON MILLED SURFACES SHALL STAGGER/OFFSET THE EXISTING JOINTS A MINIMUM OF 3 FEET WHERE POSSIBLE, TYP.
7. IN 6.0" REMOVE AND REPLACE AREAS, CONTRACTOR TO REMOVE THE UPPER 6.0" OF MATERIAL (PAVEMENT AND/OR AGGREGATE BASE) TO OVERLAY WITH 6.0" OF NEW ASPHALT PAVEMENT. CONTRACTOR TO NOTE THAT PAVEMENT CORES SHOW SEVERAL AREAS WITH LESS THAN 6.0" OF ASPHALT EXISTING. CONTRACTOR TO REMOVE BASE AS NECESSARY SO THAT NEW 6.0" ASPHALT SECTION MATCHES EXISTING ELEVATIONS. CONTRACTOR SHALL ENSURE POSITIVE DRAINAGE.

PAVEMENT MARKING NOTES

1. CONTRACTOR SHALL TAKE FIELD MEASUREMENTS OR OTHERWISE ESTABLISH A SURVEY OF THE EXISTING STRIPING IN ALL WORK AREAS IN ORDER TO ESTABLISH ALL EXISTING PAVEMENT MARKINGS WITH FULL COORDINATION OF NEW MARKINGS PROPOSED ON THIS PLAN.
2. UNLESS OTHERWISE INDICATED ON THE PLANS, THE CONTRACTOR SHALL ESTABLISH PAVEMENT MARKINGS FOR ALL FIRE LANES, DIRECTIONAL ARROWS, STOP BARS, CURBS, SIDEWALK, LIGHT POLE BASES, SIGN BASES AND PARKING STALLS TO MATCH THE EXISTING SITE WITHIN THE REPAIR LIMITS.
3. CONTRACTOR TO USE APPROPRIATE PAINT COLORS TO MATCH THE EXISTING FEATURES. ADA BARRIER FREE AREAS TO COMPLY WITH ALL LOCAL AND FEDERAL ADA STANDARDS. PAVEMENT MARKINGS SHALL BE A HIGH QUALITY PAINT RECOMMENDED BY THE PAINT MANUFACTURER. PAINT COLORS SHALL CLOSELY MATCH THE FEDERAL STANDARD 595B COLOR NUMBER AS FOLLOWS: BLUE-COLOR 15180, WHITE-COLOR 37925 AND YELLOW-COLOR 33538.

NOTE: INCIDENTAL CONSTRUCTION TO BE INCLUDED IN PAVING IMPROVEMENT LUMP SUM PRICES SHALL INCLUDE SOIL EROSION & SEDIMENTATION CONTROL, LANDSCAPING RESTORATION, TEMPORARILY REMOVING AND RESETTING CONCRETE BLOCKS OR OTHER PORTABLE DEVICES, REPLACEMENT OF PAVEMENT STRIPING AND PAVEMENT MARKINGS, STRUCTURE ADJUSTMENTS, PERMITS, AND PROVIDING BARRIER-FREE DOCUMENTATION OF COMPLETED WORK.

APPROXIMATE LOCATIONS OF INCIDENTAL CONSTRUCTION ARE SHOWN WHERE APPLICABLE. QUANTITY INCREASE OR DECREASE WHERE FOUND NECESSARY UPON SITE REVIEW WITH DESIGN CONSULTANT OR OWNER.

THIS PLAN SET IS BASED ON AUTOCAD FILES OBTAINED BY KIMLEY-HORN AND ASSOCIATES, INC. FROM PEPSICO, INC.

DRAWING RECEIVED ON: OCTOBER 11, 2023

THE CONTRACTOR IS SPECIFICALLY CAUTIONED THAT THE EXISTING INFORMATION SHOWN ON THESE PLANS IS NOT TO BE RELIED ON AS BEING EXACT OR COMPLETE. THE CONTRACTOR WILL BE RESPONSIBLE FOR FIELD VERIFYING EXISTING SITE CONDITIONS BEFORE COMMENCING CONSTRUCTION. THE CONTRACTOR MUST ALSO CALL 811 AT LEAST 72 HOURS BEFORE ANY EXCAVATION TO REQUEST EXACT FIELD LOCATION OF UTILITIES.

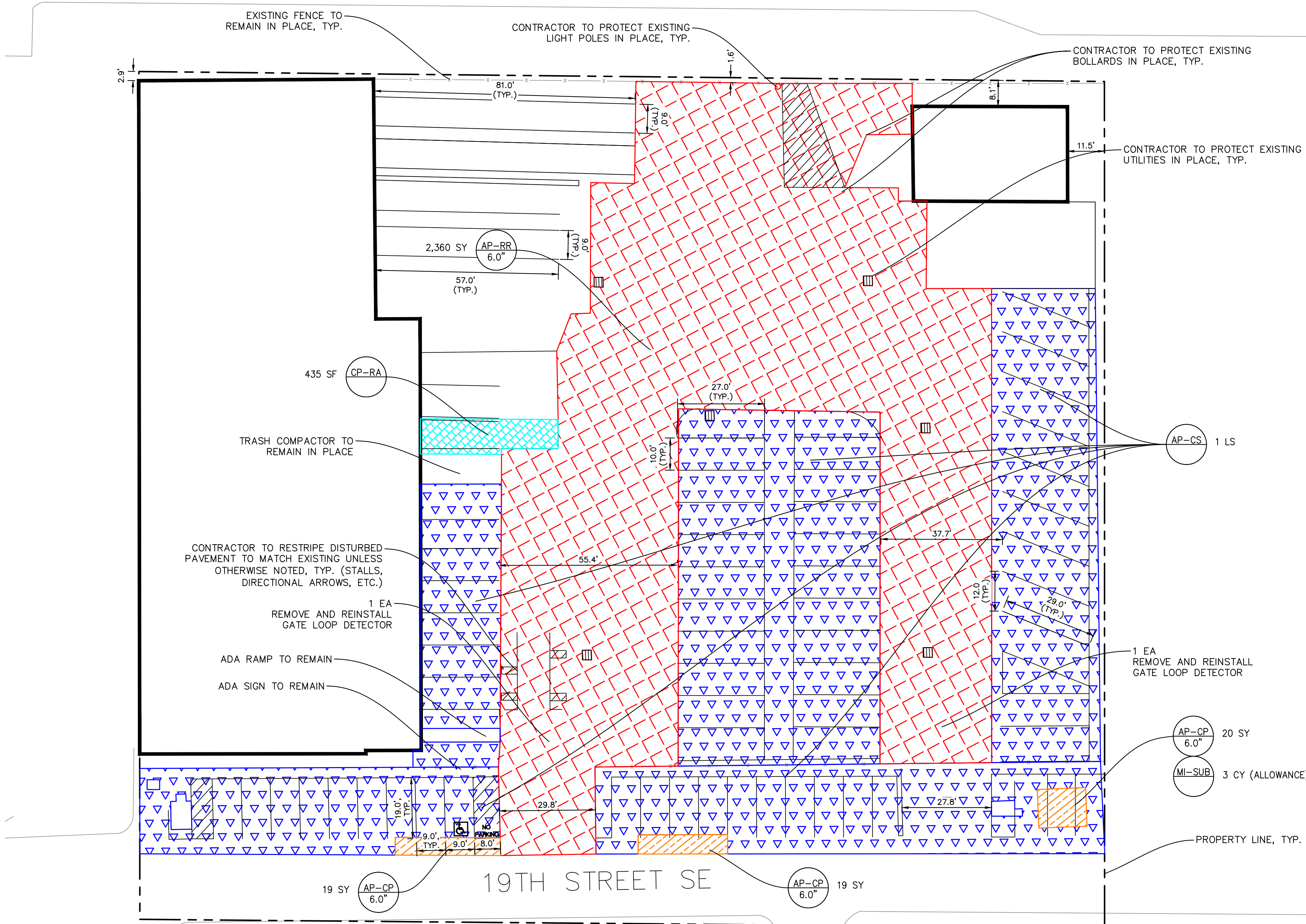

ROUND 1 COMMENTS	DATE	NO.	REVISIONS	DATE	BY
1	08/13/24 CLK				

**Kimley»Horn**  
© 2024 KIMLEY-HORN AND ASSOCIATES, INC.  
1 SOUTHWEST COLUMBIA ST, SUITE 650, PORTLAND, OR 97204  
WWW.KIMLEY-HORN.COM

KHA PROJECT 268548019	DATE 04/01/2024	SCALE AS SHOWN	DESIGNED BY CLD	DRAWN BY CLD	CHECKED BY WAD
--------------------------	--------------------	----------------	--------------------	-----------------	-------------------

SITE PLAN

FRITO-LAY  
2711 19th STREET SE  
SALEM, OR 97302-1503

SHEET NUMBER  
C1-00