

SHEET INDEX

- 1. NOTES/ SITE PLAN
- 2. NORTH ELEVATION
- 3. EAST + WEST ELEVATIONS
- 4. EXISTING 1ST FLOOR
- 5. EXISTING 2ND FLOOR
- 6. FOUNDATION PLAN + DETAIL B-6
- 7. PROPOSED 1ST FLOOR
- 8. SECTION A-8
- 9. ROOF FRAMING PLAN
- * ATTACHED ENGINEERING

GENERAL NOTES

- 1. FRAMER TO VERIFY ALL DIMENSIONS. DISCREPANCIES OF MORE THAN 2" + OR - REQUIRE CONSULTATION WITH DESIGNER.
- 2. ALL ROUGH AND FINISH FLOORS IN NEWLY CONSTRUCTED SPACES TO BE SET FLUSH WITH EXISTING FLOORS. VERIFY EXISTING FLOOR HEIGHT FOR FOUNDATION AND SECOND STORY AND ADJUST WALL HEIGHT AND FLOOR JOIST AS NEEDED.
- 3. REFER TO MANUFACTURE'S LITERATURE FOR DETAILS AND SPECIFICATIONS FOR PROPER USAGE AND INSTALLATION OF "TRUSS JOIST," "SIMPSON," AND OTHER PROPRIETARY ITEMS.
- 4. REFER TO "2023 OREGON RESIDENTIAL SPECIALTY CODE" FOR PROPER NAILING AND FASTENING OF ALL FRAMING MEMBERS INCLUDING BRACE PANELS AND ALTERNATIVE BRACE PANELS.
- 5. ALL MEASUREMENTS ARE FACE OF STUD, UNLESS OTHERWISE NOTED.

CITY OF SALEM
SALEM, OR 97301

073W23CD 05000

4002 SQ FT. FLAT LOT

NO CHANGE TO FOOTPRINT
OF BUILDING

TIE RAIN DRAINS INTO
(E) RAIN DRAIN
SYSTEM

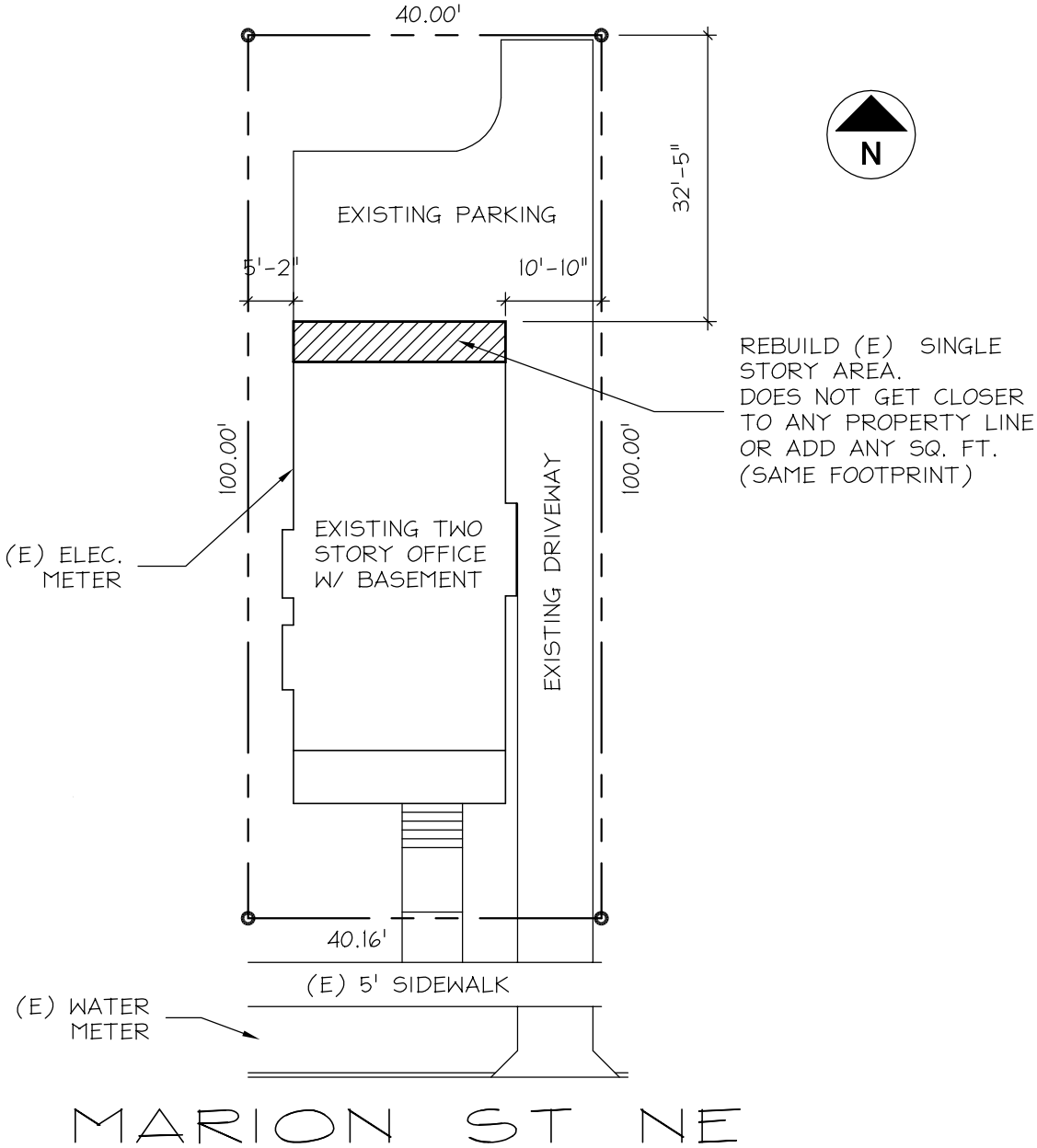

SITE PLAN

SCALE 1"=20'-0"

DESIGN\$IV

PAUL G. WILLETTS
DESIGN / DRAFTING
503-932-5473 PW4DESIGNS@YAHOO.COM

AOCE
1243 MARION ST NE
SALEM, OR 97301

DATE: 3-14-2024

FILE NAME: AOCE 2024

CLIENT: JASON C.
CRAVENHO CONST.

SHEET

1

OF 9 SHEETS