

January 10, 2024

Trent Michels
The Future of Neighborhood Development, LLC
15017 Thomas Road
Charlotte, NC 28278



RE: The Cannery (1105 Front Street NE, Salem, Oregon) – Arborist Tree Evaluation (AKS Job #5968-01)

Dear Mr. Michels,

The purpose of this letter is to provide detailed information for several trees on the Cannery Project Site. A site visit was conducted on March 23rd, 2023, to evaluate the species and condition of various trees around the project site. As shown on the attached Preliminary Tree Preservation and Removal Plan, eleven trees are proposed for removal due to site development impacts. The attached Detailed Tree Inventory provides the species and condition assessment for eight of the trees proposed for removal. Three of the trees proposed for removal (#10383, #10384, #10385) were outside of the evaluation limits at the time of my site visit and their species/condition was not recorded. However, the following information was collected during the topographic survey:

Tree #10383 - Deciduous tree with a Diameter at Breast Height (DBH) of 18" and 17".

Tree #10384 - Deciduous tree with a DBH of 15".

Tree #10385 - Deciduous tree with a DBH of 26" and 21".

Please let me know if you have any questions.

Sincerely,

AKS ENGINEERING & FORESTRY, LLC

A handwritten signature in black ink that reads 'Bennett R. Kocsis'.

Bennett R. Kocsis
Certified Arborist, Qualified Tree Risk Assessor
3700 River Road N, Suite 1
(503) 563-6151 | kocsisb@aks-eng.com



BENNETT R. KOCSIS
CERTIFICATE NUMBER: PN 8877A
EXPIRATION DATE: 12/31/2025

**PRELIMINARY TREE PRESERVATION AND REMOVAL PLAN
 THE CANNERY
 SALEM, OREGON**

REGISTERED PROFESSIONAL ENGINEER
PRELIMINARY
 NOT FOR CONSTRUCTION
 COVER D. ROTH
 RENEWS: DECEMBER 31, 2024
 JOB NUMBER: 5968-01
 DATE: 12/29/2023
 DESIGNED BY: TDR
 DRAWN BY: M.M.
 CHECKED BY: TDR

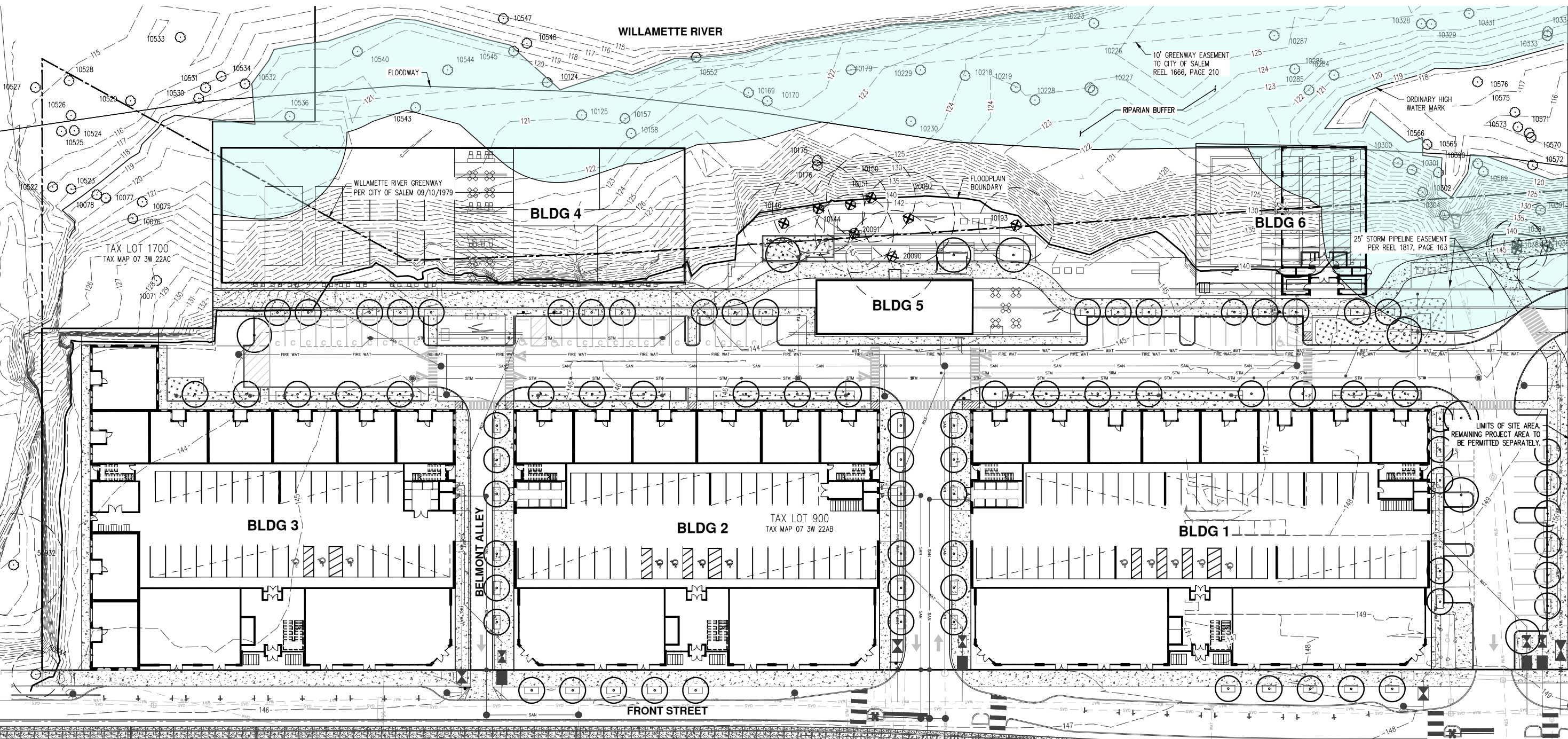

TREE SUMMARY:

TOTAL PHASE 1 TREES = XX
 TREES REMOVED FOR DEVELOPMENT = 7
 TREES REMOVED FOR GREENWAY TRAIL = 4
 TOTAL TREES SAVED = XXX

GENERAL NOTES:

1. CRITICAL ROOT ZONES SHOWN ARE FOR ANTICIPATED IMPACTED TREES ONLY.
2. TREES BELOW TOP OF BANK ARE NOT ANTICIPATED TO BE IMPACTED DUE TO BEING BELOW SITE CONSTRUCTION.

LEGEND

EXISTING GROUND CONTOUR (1 FT)	---	149
EXISTING GROUND CONTOUR (5 FT)	---	150
EXISTING TREE TO REMAIN	⊙	
EXISTING TREE TO BE REMOVED	⊗	
CRITICAL TREE ROOT ZONE 1" DBH = 1'-0" RADIUS	○	
PROPOSED TREE (REFER TO LANDSCAPE PLANS BY OTHERS)	⊕	

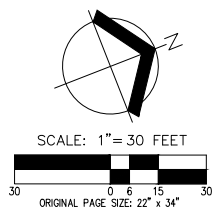

TREE TABLE			
TREE NUMBER	TYPE	DBH (IN.)	PRESERVE/REMOVE
10071	DECIDUOUS	19 18	PRESERVE
10075	DECIDUOUS	12	PRESERVE
10076	DECIDUOUS	24	PRESERVE
10077	DECIDUOUS	30	PRESERVE
10078	DECIDUOUS	34	PRESERVE
10124	DECIDUOUS	13	PRESERVE
10125	DECIDUOUS	16	PRESERVE
10144	DECIDUOUS	27	REMOVE
10146	DECIDUOUS	24	REMOVE
10150	DECIDUOUS	22	REMOVE
10151	DECIDUOUS	26	REMOVE
10157	DECIDUOUS	15 11	PRESERVE
10158	DECIDUOUS	59	PRESERVE
10169	DECIDUOUS	15	PRESERVE
10170	DECIDUOUS	47	PRESERVE
10175	DECIDUOUS	12	PRESERVE
10176	DECIDUOUS	13 11	PRESERVE
10179	DECIDUOUS	12	PRESERVE
10193	DECIDUOUS	22	REMOVE
10218	DECIDUOUS	12	PRESERVE
10219	DECIDUOUS	41	PRESERVE
10223	DECIDUOUS	11 10	PRESERVE
10226	DECIDUOUS	15	PRESERVE
10227	DECIDUOUS	12	PRESERVE
10228	DECIDUOUS	12 10	PRESERVE
10229	DECIDUOUS	14	PRESERVE
10230	DECIDUOUS	11	PRESERVE
10284	DECIDUOUS	39	PRESERVE
10285	DECIDUOUS	17	PRESERVE
10286	DECIDUOUS	10	PRESERVE
10287	DECIDUOUS	13	PRESERVE
10300	DECIDUOUS	52	PRESERVE
10301	DECIDUOUS	54	PRESERVE
10302	DECIDUOUS	19	PRESERVE
10304	DECIDUOUS	20 18	PRESERVE
10328	DECIDUOUS	16 12	PRESERVE
10329	DECIDUOUS	15	PRESERVE
10331	DECIDUOUS	42	PRESERVE
10333	DECIDUOUS	43	PRESERVE
10334	DECIDUOUS	10	PRESERVE
10383	DECIDUOUS	18 17	REMOVE

TREE TABLE			
TREE NUMBER	TYPE	DBH (IN.)	PRESERVE/REMOVE
10384	DECIDUOUS	15	REMOVE
10385	DECIDUOUS	26 21	REMOVE
10390	DECIDUOUS	UNK	PRESERVE
10391	DECIDUOUS	13	PRESERVE
10522	DECIDUOUS	28 23 16	PRESERVE
10523	DECIDUOUS	34	PRESERVE
10524	DECIDUOUS	32	PRESERVE
10525	DECIDUOUS	36	PRESERVE
10526	DECIDUOUS	44	PRESERVE
10527	DECIDUOUS	15 14	PRESERVE
10528	DECIDUOUS	11	PRESERVE
10529	DECIDUOUS	40	PRESERVE
10530	DECIDUOUS	17	PRESERVE
10531	DECIDUOUS	42	PRESERVE
10532	DECIDUOUS	41	PRESERVE
10533	DECIDUOUS	12	PRESERVE
10534	DECIDUOUS	10	PRESERVE
10536	DECIDUOUS	44	PRESERVE
10540	DECIDUOUS	14 11	PRESERVE
10543	DECIDUOUS	40	PRESERVE
10544	DECIDUOUS	28 22 21 19 16 11	PRESERVE
10545	DECIDUOUS	11	PRESERVE
10547	DECIDUOUS	13 10	PRESERVE
10548	DECIDUOUS	11 11	PRESERVE
10552	DECIDUOUS	16	PRESERVE
10565	DECIDUOUS	19 14 14 13 12 12	PRESERVE
10566	DECIDUOUS	52	PRESERVE
10569	DECIDUOUS	73	PRESERVE
10570	DECIDUOUS	17	PRESERVE
10571	DECIDUOUS	17	PRESERVE
10572	DECIDUOUS	10	PRESERVE
10573	DECIDUOUS	15	PRESERVE
10576	DECIDUOUS	11	PRESERVE
20090	DECIDUOUS	27	REMOVE
20091	DECIDUOUS	23	REMOVE
20092	DECIDUOUS	27	REMOVE
50844	DECIDUOUS	8 12 14	PRESERVE
50932	DECIDUOUS	30	PRESERVE

PRELIMINARY TREE TABLE
 THE CANNERY
 SALEM, OREGON

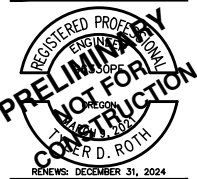

JOB NUMBER: 5968-01
 DATE: 12/29/2023
 DESIGNED BY: TDR
 DRAWN BY: M.J.M.
 CHECKED BY: TDR

Detailed Tree Inventory for The Cannery

AKS Job No. [5968-01] - Evaluation Date: 03/23/2023 - Evaluated by: BRK

Tree #	DBH (in.)	Avg. Crown Radius (ft)	Tree Species Common Name (Scientific name)	Comments	Health Rating*	Structure Rating**	Remove/Preserve
10144	27	25	Black Cottonwood (<i>Populus trichocarpa</i>)	Good Condition	1	1	Remove
10146	24	20	Black Cottonwood (<i>Populus trichocarpa</i>)	Broken codominant stem at the top; 1-sided canopy (S); Slight lean (S)	2	2	Remove
10150	22	20	Black Cottonwood (<i>Populus trichocarpa</i>)	Broken top; Large broken limb with decay; Exposed buttress roots (E) with decay; Roots on top of ground up to ~30' away	2	3	Remove
10151	26	22	Black Cottonwood (<i>Populus trichocarpa</i>)	Slight lean (E)	1	1	Remove
10193	22	17	Bigleaf Maple (<i>Acer macrophyllum</i>)	Good Condition	1	1	Remove
20090	27	29	Red Oak (<i>Quercus rubra</i>)	Exposed roots (W); 1-sided canopy (E)	1	1	Remove
20091	23	40	Red Oak (<i>Quercus rubra</i>)	1-sided canopy (SE); Top lean (SE)	1	2	Remove
20092	27	23	Red Oak (<i>Quercus rubra</i>)	Exposed buttress roots (S)	1	1	Remove

Total # of Existing Trees Inventoried = 8

***Health Rating:**

- 1 = Good Health - A tree that exhibits typical foliage, bark, and root characteristics, for its respective species, shows no signs of infection or infestation, and has a high level of vigor and vitality.
- 2 = Fair Health - A tree that exhibits some abnormal health characteristics and/or shows some signs of infection or infestation, but may be reversed or abated with supplemental treatment.
- 3 = Poor Health - A tree that is in significant decline, to the extent that supplemental treatment would not likely result in reversing or abating its decline.

****Structure Rating:**

- 1 = Good Structure - A tree that exhibits typical physical form characteristics, for its respective species, shows no signs of structural defects of the canopy, trunk, and/or root system.
- 2 = Fair Structure - A tree that exhibits some abnormal physical form characteristics and/or some signs of structural defects, which reduce the structural integrity of the tree, but are not indicative of imminent physical failure, and may be corrected using arboricultural abatement methods.
- 3 = Poor Structure - A tree that exhibits extensively abnormal physical form characteristics and/or significant structural defects that substantially reduces the structural viability of the tree, cannot feasibly be abated, and are indicative of imminent physical failure.

Arborist Disclosure Statement:

Arborists are tree specialists who use their education, knowledge, training, and experience to examine trees, recommend measures to enhance the health of trees, and attempt to reduce the risk of living near trees. The Client and Jurisdiction may choose to accept or disregard the recommendations of the arborist, or seek additional advice. Arborists cannot detect every condition that could possibly lead to the structural failure of a tree. Trees are living organisms that fail in ways we do not fully understand. Conditions are often hidden within trees and below ground. Arborists cannot guarantee that a tree will be healthy or safe under all circumstances, or for a specified period of time. Likewise, remedial treatments, like medicine, cannot be guaranteed. Trees can be managed, but they cannot be controlled. To live near trees is to accept some degree of risk. The only way to eliminate all risk associated with trees is to eliminate all trees. Neither this author nor AKS Engineering & Forestry, LLC have assumed any responsibility for liability associated with the trees on or adjacent to this site.

At the completion of construction, all trees should once again be reviewed. Land clearing and removal of adjacent trees can expose previously unseen defects and otherwise healthy trees can be damaged during construction.